

CUMMINS ENGINE KIT

QUICK REFERENCE CHART



World Tested. Performance Proven.





PAI INDUSTRIES, INC.

===== WORLD TESTED PERFORMANCE PROVEN =====

Your Official Supplier for High Performance Truck Parts.

We are proud to be an American Manufacturer for over 40 years. Our goal is to ensure customer satisfaction by maintaining the highest levels of quality for the products and services we provide. For that reason, we perform rigorous testing to ensure greater efficiency, longer life and lower maintenance needs.

Visit: www.paiindustries.com



ISO 9001
CERTIFIED

CUMMINS

ENGINE KIT QUICK REFERENCE CHARTS

HP Now offering High Performance for select Engine Kits **HP**

PAI INDUSTRIES, INC., 950 Northbrook Parkway, Suwanee, GA 30024
P: 770.822.1000 • F: 770.822.1421 • www.paiindustries.com



PAI CUMMINS ENGINE KITS

ISO 9001 CERTIFIED

HP PART(S) AVAILABLE IN STANDARD AND HIGH PERFORMANCE

Cummins Inframe Kit Breakdown Small Cam with Early Rod 855000-(*) THRU 855019-(*)

Inframe Kit No.	Piston	Piston OEM Ref.
855000-(*)	111104	3017348
855001-(*)	111109	3017349
HP 855002-(*)	111107	3028685
855006-(*)	111124	3042320
855007-(*)	111129	3045948
855008-(*)	111144	3048650
855009-(*)	111146	3048808
855010-(*)	111148	3048809
855011-(*)	111150	3050366
855012-(*)	111101	3050480
855013-(*)	111127	3051553
855014-(*)	111132	3051554
855015-(*)	111134	3051555
855016-(*)	111114	3051556
855017-(*)	111119	3051557
855019-(*)	111139	3069212

COMMON COMPONENTS			
PAI Ref.	OEM Ref.	Description	Qty.
HP 171720	3801260	Main Bearing Kit	1
HP 171745	203660	Rod Bearings	12
131316	3801348	Upper Gasket Kit	1
131394	3804303	Pan Gasket Kit	1
HP 505070(P)	4089810	Ring Sets	6
HP 505025(P+)	3803471		
HP 111094	191970	Pins	6
111095	175755	Retainers	12
HP 161601	3801826	Liner Kits	6

Dual-NI Piston Overhaul Kits always recommend using Premium+ Ring Sets.

(P) = PREMIUM • (P+)=PREMIUM PLUS • (E)=EARLY STYLE SLEEVE KITS • (C)=CURRENT STYLE SLEEVE KITS
KITS ARE AVAILABLE WITH OVERSIZED LINERS & BEARINGS (CALL TECHNICAL SUPPORT FOR DASH #'s)

Please note: Specify size of Rod Bearings and Main Bearings when ordering Rebuild Kits. All OEM references shown are examples of standard sizes. Other sizes are available. Please call for correct dash number for application. **MUST VERIFY BY SERIAL AND ARRANGEMENT.**



PAI CUMMINS ENGINE KITS

ISO 9001 CERTIFIED

HP PART(S) AVAILABLE IN STANDARD AND HIGH PERFORMANCE

Cummins Inframe Kit Breakdown Big Cam I, II, III with Late Rod 855020-(*) THRU 855039-(*)

Inframe Kit No.	Piston	Piston OEM Ref.
855020-(*)	111104	3017348
855021-(*)	111109	3017349
855022-(*)	111107	3028685
855024-(*)	111152	3042318
855025-(*)	111141	3042319
855026-(*)	111124	3042320
855027-(*)	111129	3045948
855028-(*)	111144	3048650
HP 855029-(*)	111146	3048808
855030-(*)	111148	3048809
855031-(*)	111150	3050366
855032-(*)	111101	3050480
855033-(*)	111127	3051553
855034-(*)	111132	3051554
855035-(*)	111134	3051555
855036-(*)	111114	3051556
855037-(*)	111119	3051557
855038-(*)	111121	3052794
855039-(*)	111139	3069212

COMMON COMPONENTS			
PAI Ref.	OEM Ref.	Description	Qty.
HP 171720	3801260	Main Bearing Kit	1
HP 171765	214950	Rod Bearings	12
131316	3801348	Upper Gasket Kit	1
131394	3804303	Pan Gasket Kit	1
HP 505070(P)	4089810	Ring Sets	6
HP 505025(P+)	3803471		
HP 111094	191970	Pins	6
111095	175755	Retainers	12
HP 161601	3801826	Liner Kits	6

Dual-NI Piston Overhaul Kits always recommend using Premium+ Ring Sets.

(P) = PREMIUM • (P+)=PREMIUM PLUS • (E)=EARLY STYLE SLEEVE KITS • (C)=CURRENT STYLE SLEEVE KITS
KITS ARE AVAILABLE WITH OVERSIZED LINERS & BEARINGS (CALL TECHNICAL SUPPORT FOR DASH #'s)

Please note: Specify size of Rod Bearings and Main Bearings when ordering Rebuild Kits. All OEM references shown are examples of standard sizes. Other sizes are available. Please call for correct dash number for application. **MUST VERIFY BY SERIAL AND ARRANGEMENT.**



PAI CUMMINS ENGINE KITS

ISO 9001 CERTIFIED

HP PART(S) AVAILABLE IN STANDARD AND HIGH PERFORMANCE

Cummins Inframe Kit Breakdown Big Cam IV 5 Bolt Valve Cover 855040-(*) THRU 855059-(*)

Inframe Kit No.	Piston	Piston OEM Ref.
855042-(*)	111107	3028685
855044-(*)	111152	3042318
855045-(*)	111141	3042319
855046-(*)	111124	3042320
855047-(*)	111129	3045948
855048-(*)	111144	3048650
855049-(*)	111146	3048808
855050-(*)	111148	3048809
855051-(*)	111150	3050366
855052-(*)	111101	3050480
855055-(*)	111134	3051555
855056-(*)	111114	3051556
855057-(*)	111119	3051557
855058-(*)	111121	3052794
855059-(*)	111139	3069212
855345-(*)	111641	3095746

COMMON COMPONENTS			
PAI Ref.	OEM Ref.	Description	Qty.
HP 171720	3801260	Main Bearing Kit	1
HP 171765	214950	Rod Bearings	12
131350	N/A	Upper Gasket Kit	1
131394	3804303	Pan Gasket Kit	1
HP 505070(P)	4089810	Ring Sets	6
HP 505025(P+)	3803471		
HP 111094	191970	Pins	6
111095	175755	Retainers	12
HP 161601	3801826	Liner Kits	6

Dual-NI Piston Overhaul Kits always recommend using Premium+ Ring Sets.

(P) = PREMIUM • (P+)=PREMIUM PLUS • (E)=EARLY STYLE SLEEVE KITS • (C)=CURRENT STYLE SLEEVE KITS
KITS ARE AVAILABLE WITH OVERSIZED LINERS & BEARINGS (CALL TECHNICAL SUPPORT FOR DASH #'s)

Please note: Specify size of Rod Bearings and Main Bearings when ordering Rebuild Kits. All OEM references shown are examples of standard sizes. Other sizes are available. Please call for correct dash number for application. **MUST VERIFY BY SERIAL AND ARRANGEMENT.**



PAI CUMMINS ENGINE KITS

ISO 9001 CERTIFIED

HP PART(S) AVAILABLE IN STANDARD AND HIGH PERFORMANCE

Cummins Inframe Kit Breakdown Big Cam IV 7 Bolt Valve Cover 855060-(*) THRU 855079-(*)

Inframe Kit No.	Piston	Piston OEM Ref
855062-(*)	111107	3028685
855067-(*)	111129	3045948
855069-(*)	111146	3048808
855070-(*)	111148	3048809
855072-(*)	111101	3050480
855075-(*)	111134	3051555
855077-(*)	111119	3051557
855078-(*)	111121	3052794
HP 855079-(*)	111139	3069212

COMMON COMPONENTS			
PAI Ref.	OEM Ref.	Description	Qty.
HP 171720	3801260	Main Bearing Kit	1
HP 171765	214950	Rod Bearings	12
131328	3803040	Upper Gasket Kit	1
131394	3804303	Pan Gasket Kit	1
HP 505070(P)	4089810	Ring Sets	6
HP 505025(P+)	3803471		
HP 111094	191970	Pins	6
111095	175755	Retainers	12
HP 161601	3801826	Liner Kits	6

Dual-NI Piston Overhaul Kits always recommend using Premium+ Ring Sets.

(P) = PREMIUM • (P+)=PREMIUM PLUS • (E)=EARLY STYLE SLEEVE KITS • (C)=CURRENT STYLE SLEEVE KITS
KITS ARE AVAILABLE WITH OVERSIZED LINERS & BEARINGS (CALL TECHNICAL SUPPORT FOR DASH #'s)

Please note: Specify size of Rod Bearings and Main Bearings when ordering Rebuild Kits. All OEM references shown are examples of standard sizes. Other sizes are available. Please call for correct dash number for application. **MUST VERIFY BY SERIAL AND ARRANGEMENT.**



PAI CUMMINS ENGINE KITS

ISO 9001 CERTIFIED

HP PART(S) AVAILABLE IN STANDARD AND HIGH PERFORMANCE

855 SERIES

855080-(*) INFRAME KIT NATURAL GAS ENGINE BIG CAM			
PAI Ref.	OEM Ref.	Description	Qty.
171720	3801260	Main Bearing Kit	1
171765	214950	Rod Bearings	12 pcs
131564	3804276	Upper Gasket Kit	1
131394	3804303	Pan Gasket Kit	1
101151	N/A	Cylinder Kits	6
Cylinder Kit Includes			
111665	166630	Piston	1
HP 111094	191970	Pin	1
111095	175755	Retainers	2
161600	3055099	Liner	1
121201	AR51477	O-Ring Kit	1
HP 505025(P+)	3803471	Ring Set	1

855 SERIES

855081-(*) INFRAME KIT NATURAL GAS ENGINE BIG CAM			
PAI Ref.	OEM Ref.	Description	Qty.
171720	3801260	Main Bearing Kit	1
171765	214950	Rod Bearings	12 pcs
131564	3804276	Upper Gasket Kit	1
131394	3804303	Pan Gasket Kit	1
101146	N/A	Cylinder Kits	6
Cylinder Kit Includes			
111674	3226009	Piston	1
HP 111094	191970	Pin	1
111095	175755	Retainers	2
161600	3055099	Liner	1
121201	AR51477	O-Ring Kit	1
HP 505025(P+)	3803471	Ring Set	1

855 SERIES

855082-(*) INFRAME KIT NATURAL GAS ENGINE BIG CAM			
PAI Ref.	OEM Ref.	Description	Qty.
171720	3801260	Main Bearing Kit	1
171765	214950	Rod Bearings	12 pcs
131564	3804276	Upper Gasket Kit	1
131394	3804303	Pan Gasket Kit	1
101143	N/A	Cylinder Kits	6
Cylinder Kit Includes			
111452	3226010	Piston	1
HP 111094	191970	Pin	1
111095	175755	Retainers	2
161600	3055099	Liner	1
121201	AR51477	O-Ring Kit	1
HP 505025(P+)	3803471	Ring Set	1

855 SERIES

855100-(*) INFRAME KIT BIG CAM			
PAI Ref.	OEM Ref.	Description	Qty.
171720	3801260	Main Bearing Kit	1
171765	214950	Rod Bearings	12 pcs
131328	3803040	Upper Gasket Kit	1
131394	3804303	Pan Gasket Kit	1
101133	N/A	Cylinder Kits	6
Cylinder Kit Includes			
111663	3058566	Piston	1
HP 111094	191970	Pin	1
111095	175755	Retainers	2
161600	3055099	Liner	1
121201	AR51477	O-Ring Kit	1
HP 505025(P+)	3803471	Ring Set	1

(P) = PREMIUM • (P+)=PREMIUM PLUS • (E)=EARLY STYLE SLEEVE KITS • (C)=CURRENT STYLE SLEEVE KITS
KITS ARE AVAILABLE WITH OVERSIZED LINERS & BEARINGS (CALL TECHNICAL SUPPORT FOR DASH #'s)

Please note: Specify size of Rod Bearings and Main Bearings when ordering Rebuild Kits. All OEM references shown are examples of standard sizes. Other sizes are available. Please call for correct dash number for application. **MUST VERIFY BY SERIAL AND ARRANGEMENT.**



PAI CUMMINS ENGINE KITS

ISO 9001 CERTIFIED

HP PART(S) AVAILABLE IN STANDARD AND HIGH PERFORMANCE

855 SERIES

855345-(*) INFRAME KIT TRI-TECH PISTON BIG CAM			
PAI Ref.	OEM Ref.	Description	Qty.
171720	3801260	Main Bearing Kit	1
171765	214950	Rod Bearings	12 pcs
131350	N/A	Upper Gasket Kit	1
131394	3804303	Pan Gasket Kit	1
101159	3804442	Cylinder Kits	6
Cylinder Kit Includes			
111641	3095746	Piston	1
HP 111094	191970	Pin	1
111095	175755	Retainers	2
161600	3055099	Liner	1
121201	AR51477	O-Ring	1
HP 505064	4089489	Ring Set	1

FOR OUR COMPLETE CUMMINS ENGINE SELECTION CALL 770.822.1000

(P) = PREMIUM • (P+)=PREMIUM PLUS • (E)=EARLY STYLE SLEEVE KITS • (C)=CURRENT STYLE SLEEVE KITS
KITS ARE AVAILABLE WITH OVERSIZED LINERS & BEARINGS (CALL TECHNICAL SUPPORT FOR DASH #'s)

Please note: Specify size of Rod Bearings and Main Bearings when ordering Rebuild Kits. All OEM references shown are examples of standard sizes. Other sizes are available. Please call for correct dash number for application. **MUST VERIFY BY SERIAL AND ARRANGEMENT.**



PAI CUMMINS ENGINE KITS

ISO 9001 CERTIFIED

HP PART(S) AVAILABLE IN STANDARD AND HIGH PERFORMANCE

N14 SERIES

N14101-(*) REBUILD KITS			
PAI Ref.	OEM Ref.	Description	Qty.
HP 171720	3801260	Main Bearing Kit	1
HP 171784	3055145	Rod Bearings	12 pcs
131272	3804286	Upper Gasket Kit	1
131394	3804303	Pan Gasket Kit	1
101066	3803757	Cylinder Kits	6
Cylinder Kit Includes			
111164	3081267	Piston	1
HP 111170	3064304	Pin	1
111171	3064305	Retainers	2
161600	3055099	Liner	1
121201	AR51477	O-Ring Kit	1
HP 505064	4089489	Ring Set	1

N14 SERIES

N14102-(*) REBUILD KITS			
PAI Ref.	OEM Ref.	Description	Qty.
HP 171720	3801260	Main Bearing Kit	1
HP 171784	3055145	Rod Bearings	12 pcs
131272	3804286	Upper Gasket Kit	1
131394	3804303	Pan Gasket Kit	1
101065	3803759	Cylinder Kits	6
Cylinder Kit Includes			
111169	3081269	Piston	1
HP 111170	3064304	Pin	1
111171	3064305	Retainers	2
161600	3055099	Liner	1
121201	AR51477	O-Ring Kit	1
HP 505064	4089489	Ring Set	1

N14 SERIES

N14103-(*) REBUILD KITS			
PAI Ref.	OEM Ref.	Description	Qty.
HP 171720	3801260	Main Bearing Kit	1
HP 171784	3055145	Rod Bearings	12 pcs
131271	3804287	Upper Gasket Kit	1
131394	3804303	Pan Gasket Kit	1
101063	3803753	Cylinder Kits	6
Cylinder Kit Includes			
111162	3081266	Piston	1
HP 111170	3064304	Pin	1
111171	3064305	Retainers	2
161600	3055099	Liner	1
121201	AR51477	O-Ring Kit	1
HP 505064	4089489	Ring Set	1

N14 SERIES

N14104-(*) REBUILD KITS			
PAI Ref.	OEM Ref.	Description	Qty.
HP 171720	3801260	Main Bearing Kit	1
HP 171784	3055145	Rod Bearings	12 pcs
131271	3804287	Upper Gasket Kit	1
131394	3804303	Pan Gasket Kit	1
101064	3803755	Cylinder Kits	6
Cylinder Kit Includes			
111168	3081268	Piston	1
HP 111170	3064304	Pin	1
111171	3064305	Retainers	2
161600	3055099	Liner	1
121201	AR51477	O-Ring Kit	1
HP 505064	4089489	Ring Set	1

(P) = PREMIUM • (P+)=PREMIUM PLUS • (E)=EARLY STYLE SLEEVE KITS • (C)=CURRENT STYLE SLEEVE KITS
 KITS ARE AVAILABLE WITH OVERSIZED LINERS & BEARINGS (CALL TECHNICAL SUPPORT FOR DASH #'s)

Please note: Specify size of Rod Bearings and Main Bearings when ordering Rebuild Kits. All OEM references shown are examples of standard sizes. Other sizes are available. Please call for correct dash number for application. **MUST VERIFY BY SERIAL AND ARRANGEMENT.**

Online Login/Registration



1 PAI HOMEPAGE

Customer “Login” and “Register” links are located to the upper right corner of our homepage.

Select Login if you have already registered ([Skip to Step 4](#)). To register, select the “Register” link which will take you to PAI’s registration form.

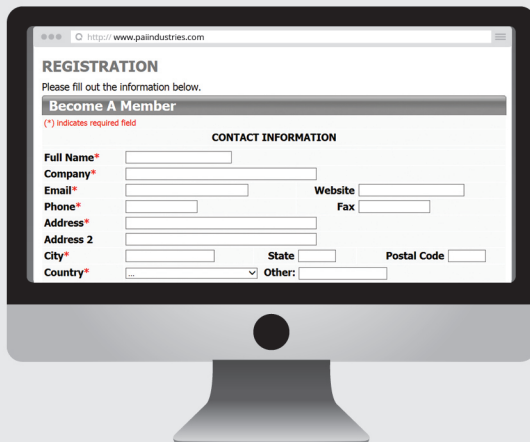

2 PAI ONLINE REGISTRATION FORM

Fill in all required fields of the registration form. After the form is completed, read our Terms and Conditions then click “Sign-Up.” A confirmation “Thank You” page will appear once all required fields are filled in. Required Fields are marked with asterisk (*).

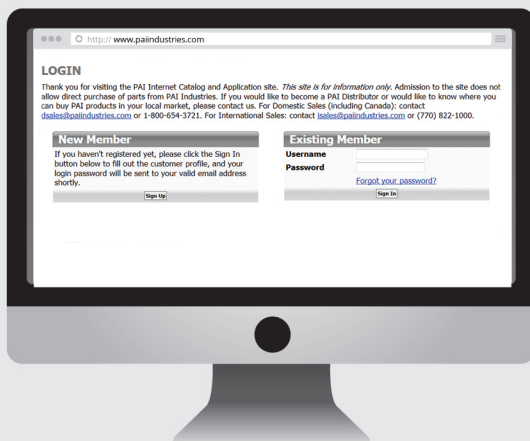

3 CONFIRMATION EMAIL

A confirmation email will be sent to the email address provided. This email will include your new PAI “Username” and “Password.”

4 PAI SECURE LOGIN PAGE

To login, use the “Existing Member” box and enter your PAI “Username” and “Password” then click “Sign-In.”



PAI CUMMINS ENGINE KITS

ISO 9001 CERTIFIED

HP PART(S) AVAILABLE IN STANDARD AND HIGH PERFORMANCE

N14 SERIES

N14124-(*) REBUILD KITS CROWNLESS			
PAI Ref.	OEM Ref.	Description	Qty.
HP 171720	3801260	Main Bearing Kit	1
HP 171784	3055145	Rod Bearings	12 pcs
131264	4089371	Upper Gasket Kit	1
131394	3804303	Pan Gasket Kit	1
HP 505064	4089489	Ring Sets	6
161601	3801826	Liner Kits	6
Piston Components			
111384	N/A	Skirts	6
HP 111170	3064304	Pins	6
111171	3064305	Retainers	12

N14 SERIES

N14125-(*) OVERHAUL KITS PISTONLESS			
PAI Ref.	OEM Ref.	Description	Qty.
HP 171720	3801260	Main Bearing Kit	1
HP 171784	3055145	Rod Bearings	12 pcs
131264	4089371	Upper Gasket Kit	1
131273	3803613	Lower Gasket Kit	1
Components			
111171	3064305	Retainers	12
161601	3801826	Liner Kits	6
HP 505064	4089489	Ring Sets	6

N14 SERIES

N14126-(*) REBUILD KITS PISTONLESS OVERHAUL			
PAI Ref.	OEM Ref.	Description	Qty.
HP 171720	3801260	Main Bearing Kit	1
HP 171784	3055145	Rod Bearings	12 pcs
131264	4089371	Upper Gasket Kit	1
131539	3804635	Pan Gasket Kit	1
151501	3801106	Cam Bearing Set	1
Components			
161601	3801826	Liner Kits	6
HP 505064	4089489	Ring Sets	6

N14 SERIES

HP N14221-(*) INFRAME KITS			
PAI Ref.	OEM Ref.	Description	Qty.
HP 171720	3801260	Main Bearing Kit	1
HP 171784	3055145	Rod Bearings	12 pcs
131264	4089371	Upper Gasket Kit	1
131394	3804303	Pan Gasket Kit	1
101092	N/A	Cylinder Kits	6
Cylinder Kit Includes			
HP 111478	N/A	Piston Kit	1
HP 111170	3064304	Pin	1
111171	3064305	Retainers	2
161601	3801826	Liner Kit	1
HP 505064	4089489	Ring Set	1

(P) = PREMIUM • (P+)=PREMIUM PLUS • (E)=EARLY STYLE SLEEVE KITS • (C)=CURRENT STYLE SLEEVE KITS
 KITS ARE AVAILABLE WITH OVERSIZED LINERS & BEARINGS (CALL TECHNICAL SUPPORT FOR DASH #'s)

Please note: Specify size of Rod Bearings and Main Bearings when ordering Rebuild Kits. All OEM references shown are examples of standard sizes. Other sizes are available. Please call for correct dash number for application. **MUST VERIFY BY SERIAL AND ARRANGEMENT.**



PAI CUMMINS ENGINE KITS

ISO 9001 CERTIFIED

HP PART(S) AVAILABLE IN STANDARD AND HIGH PERFORMANCE

N14 SERIES

HP N14222-(*) INFRAME KITS			
PAI Ref.	OEM Ref.	Description	Qty.
HP 171720	3801260	Main Bearing Kit	1
HP 171784	3055145	Rod Bearings	12 pcs
131264	4089371	Upper Gasket Kit	1
131394	3804303	Pan Gasket Kit	1
101098	N/A	Cylinder Kits	6
Cylinder Kit Includes			
HP 111487	N/A	Piston Kit	1
HP 111170	3064304	Pin	1
111171	3064305	Retainers	2
161601	3801826	Liner Kit	1
HP 505057	N/A	Ring Set	1

N14 SERIES

N14223-(*) INFRAME KITS			
PAI Ref.	OEM Ref.	Description	Qty.
HP 171720	3801260	Main Bearing Kit	1
HP 171784	3055145	Rod Bearings	12 pcs
131264	4089371	Upper Gasket Kit	1
131394	3804303	Pan Gasket Kit	1
101101	N/A	Cylinder Kits	6
Cylinder Kit Includes			
111484	N/A	Piston Kit	1
HP 111170	3064304	Pin	1
111171	3064305	Retainers	2
161601	3801826	Liner Kit	1
HP 505057	N/A	Ring Set	1

FOR OUR COMPLETE CUMMINS ENGINE SELECTION CALL 770.822.1000

(P) = PREMIUM • (P+)=PREMIUM PLUS • (E)=EARLY STYLE SLEEVE KITS • (C)=CURRENT STYLE SLEEVE KITS
 KITS ARE AVAILABLE WITH OVERSIZED LINERS & BEARINGS (CALL TECHNICAL SUPPORT FOR DASH #'s)

Please note: Specify size of Rod Bearings and Main Bearings when ordering Rebuild Kits. All OEM references shown are examples of standard sizes. Other sizes are available. Please call for correct dash number for application. **MUST VERIFY BY SERIAL AND ARRANGEMENT.**



PAI CUMMINS ENGINE KITS

ISO 9001 CERTIFIED

HP PART(S) AVAILABLE IN STANDARD AND HIGH PERFORMANCE

ISX SERIES

ISX101-(*) INFRAME KIT PRE-EGR & EGR ENGINE			
PAI Ref.	OEM Ref.	Description	Qty.
HP 171980	3800298	Main Bearing Kit	1
HP 171990	4089405	Rod Bearings	6 prs
131637	4955595	Upper Gasket Kit	1
131638	4955596		
131656	4026684	Pan Gasket Kit	1
101165	N/A	Cylinder Kits	6
Cylinder Kit Includes			
111550	4923745	Piston	1
HP 111089	4923748	Pin	1
111171	3064305	Retainers	2
HP 505125	4089406	Ring Set	1
161647	4089153	Liner Kit	1

ISX SERIES

ISX102-(*) INFRAME KIT PRE-EGR & EGR ENGINE			
PAI Ref.	OEM Ref.	Description	Qty.
HP 171980	3800298	Main Bearing Kit	1
HP 171990	4089405	Rod Bearings	6 prs
131637	4955595	Upper Gasket Kit	1
131638	4955596		
131656	4026684	Pan Gasket Kit	1
101166	N/A	Cylinder Kits	6
Cylinder Kit Includes			
111569	4923747	Piston	1
HP 111089	4923748	Pin	1
111171	3064305	Retainers	2
HP 505125	4089406	Ring Set	1
161647	4089153	Liner Kit	1

ISX SERIES

ISX103-(*) INFRAME KIT PRE-EGR & EGR ENGINE			
PAI Ref.	OEM Ref.	Description	Qty.
HP 171980	3800298	Main Bearing Kit	1
HP 171990	4089405	Rod Bearings	6 prs
131637	4955595	Upper Gasket Kit	1
131638	4955596		
131656	4026684	Pan Gasket Kit	1
101167	N/A	Cylinder Kits	6
Cylinder Kit Includes			
111560	4923743	Piston	1
HP 111089	4923748	Pin	1
111171	3064305	Retainers	2
HP 505125	4089406	Ring Set	1
161647	4089153	Liner Kit	1

ISX SERIES

ISX104-033-096 INFRAME KIT PRE-EGR ENGINE			
PAI Ref.	OEM Ref.	Description	Qty.
HP 171980	3800298	Main Bearing Kit	1
HP 171990	4089405	Rod Bearings	6 prs
131637	4955595	Upper Gasket Kit	1
131906	2881767		
131838	N/A	Pan Gasket Kit	1
101169	N/A	Cylinder Kits	6
101175	N/A		
101176	N/A		
Cylinder Kit Includes			
111563	4923744	Piston	1
HP 111089	4923748	Pin	1
111171	3064305	Retainers	2
HP 505125	4089406	Ring Set	1
161647	4089153	Liner Kit	1
161649	2881719		



PAI CUMMINS ENGINE KITS

ISO 9001 CERTIFIED

HP PART(S) AVAILABLE IN STANDARD AND HIGH PERFORMANCE

ISX SERIES

ISX104-097-112 INFRAME KIT PRE-EGR ENGINE			
PAI Ref.	OEM Ref.	Description	Qty.
HP 171980	3800298	Main Bearing Kit	1
HP 171990	4089405	Rod Bearings	6 prs
131637	4955595	Upper Gasket Kit	1
131838	N/A	Pan Gasket Kit	1
101176	N/A	Cylinder Kits	6
Cylinder Kit Includes			
111563	4923744	Piston	1
HP 111089	4923748	Pin	1
111171	3064305	Retainers	2
HP 505125	4089406	Ring Set	1
161651	4309389	Liner Kit	1

ISX SERIES

HP ISX105-097-112 INFRAME KIT PRE-EGR ENGINE			
PAI Ref.	OEM Ref.	Description	Qty.
HP 171980	3800298	Main Bearing Kit	1
HP 171990	4089405	Rod Bearings	6 prs
131637	4955595	Upper Gasket Kit	1
131656	4026684	Pan Gasket Kit	1
180240	4357177	Oil Bypass Plunger	1
101174	N/A	Cylinder Kits	6
Cylinder Kit Includes			
HP 111650	2882635	Piston	1
HP 111089	4923748	Pin	1
111171	3064305	Retainers	2
HP 505175	2881682	Ring Set	1
161652	4309389	Liner Kit	1

ISX SERIES

HP ISX105-017-096 INFRAME KIT EGR ENGINE			
PAI Ref.	OEM Ref.	Description	Qty.
HP 171980	3800298	Main Bearing Kit	1
HP 171990	4089405	Rod Bearings	6 prs
131637	4955595	Upper Gasket Kit	1
131638	4955596		
131656	4026684	Pan Gasket Kit	1
101172	N/A	Cylinder Kits	6
101173	N/A		
101174	N/A		
Cylinder Kit Includes			
HP 111650	2882635	Piston	1
HP 111089	4923748	Pin	1
111171	3064305	Retainers	2
HP 505175	2881682	Ring Set	1
161647	4089153	Liner Kit	1
161649	2881719		
161651	4309389		

(P) = PREMIUM • (P+)=PREMIUM PLUS • (E)=EARLY STYLE SLEEVE KITS • (C)=CURRENT STYLE SLEEVE KITS
KITS ARE AVAILABLE WITH OVERSIZED LINERS & BEARINGS (CALL TECHNICAL SUPPORT FOR DASH #'s)

Please note: Specify size of Rod Bearings and Main Bearings when ordering Rebuild Kits. All OEM references shown are examples of standard sizes. Other sizes are available. Please call for correct dash number for application. **MUST VERIFY BY SERIAL AND ARRANGEMENT.**



PAI CUMMINS ENGINE KITS

ISO 9001 CERTIFIED

HP PART(S) AVAILABLE IN STANDARD AND HIGH PERFORMANCE

ISX SERIES

ISX SERIES

ISX105-113-128 INFRAME KIT PRE-EGR ENGINE

PAI Ref.	OEM Ref.	Description	Qty.
HP 171980	3800298	Main Bearing Kit	1
172045	2882087	Rod Bearings	6 prs
131637	4955595	Upper Gasket Kit	1
131838	N/A	Pan Gasket Kit	1
050524	3331096	Fuel / Water Filter	1
050514	4367100	Oil Filter	1
180240	4357177	Oil Relief Valve	1
101199	N/A	Cylinder Kits	6
Cylinder Kit Includes			
HP 111650	2882635	Piston	1
HP 111089	4923748	Pin	1
111171	3064305	Retainers	2
HP 505175	2881682	Ring Set	1
161655	4376168	Liner Kit	1
Liner Kit Includes			
161654	3690557	Liner	1
121311	3678738	Seal	1
161996	3689871	Anti-Polishing Ring	1

ISX105-129-144 INFRAME KIT PRE-EGR ENGINE

PAI Ref.	OEM Ref.	Description	Qty.
HP 171980	3800298	Main Bearing Kit	1
172045	2882087	Rod Bearings	6 prs
131637	4955595	Upper Gasket Kit	1
131838	N/A	Pan Gasket Kit	1
050524	3331096	Fuel / Water Filter	1
050514	4367100	Oil Filter	1
180240	4357177	Oil Relief Valve	1
101200	N/A	Cylinder Kits	6
Cylinder Kit Includes			
HP 111650	2882635	Piston	1
HP 111089	4923748	Pin	1
111171	3064305	Retainers	2
HP 505175	2881682	Ring Set	1
161658	4376391	Liner Kit	1
Liner Kit Includes			
161657	4373362	Liner	1
121400	3685234	Seal	1
162030	5298565		
161996	3689871	Anti-Polishing Ring	1

(P) = PREMIUM • (P+)=PREMIUM PLUS • (E)=EARLY STYLE SLEEVE KITS • (C)=CURRENT STYLE SLEEVE KITS
KITS ARE AVAILABLE WITH OVERSIZED LINERS & BEARINGS (CALL TECHNICAL SUPPORT FOR DASH #'s)

Please note: Specify size of Rod Bearings and Main Bearings when ordering Rebuild Kits. All OEM references shown are examples of standard sizes. Other sizes are available. Please call for correct dash number for application. **MUST VERIFY BY SERIAL AND ARRANGEMENT.**



PAI CUMMINS ENGINE KITS

ISO 9001 CERTIFIED

HP PART(S) AVAILABLE IN STANDARD AND HIGH PERFORMANCE

ISX SERIES

HP ISX106-017-048 INFRAME KIT EGR ENGINE			
PAI Ref.	OEM Ref.	Description	Qty.
HP 171980	3800298	Main Bearing Kit	1
HP 171990	4089405	Rod Bearings	6 prs
131638	4955596	Upper Gasket Kit	1
131838	N/A	Pan Gasket Kit	1
101171	N/A	Cylinder Kits	6
101181	N/A		
Cylinder Kit Includes			
HP 111656	2882631	Piston	1
HP 111089	4923748	Pin	1
111171	3064305	Retainers	2
HP 505175	2881682	Ring Set	1
161647	4089153	Liner Kit	1

ISX SERIES

HP ISX106-081-112 INFRAME KIT EGR ENGINE			
PAI Ref.	OEM Ref.	Description	Qty.
HP 171980	3800298	Main Bearing Kit	1
HP 171990	4089405	Rod Bearings	6 prs
131637	4955595	Upper Gasket Kit	1
131638	4955596		
131838	N/A	Pan Gasket Kit	1
141307	3820320	Bypass Plunger	1
101181	N/A	Cylinder Kits	6
Cylinder Kit Includes			
HP 111656	2882631	Piston	1
HP 111089	4923748	Pin	1
111171	3064305	Retainers	2
HP 505175	2881682	Ring Set	1
161651	4309389	Liner Kit	1

ISX SERIES

HP ISX106-113-128 INFRAME KIT EGR ENGINE			
PAI Ref.	OEM Ref.	Description	Qty.
HP 171980	3800298	Main Bearing Kit	1
172045	4089405	Fractured Rod Bearings	6 prs
131638	4955596	Upper Gasket Kit	1
131838	N/A	Pan Gasket Kit	1
050504	4920586	Fuel Filter	1
050514	4367100	Oil Filter	1
180240	4357177	Bypass Plunger	1
101206	N/A	Cylinder Kits	6
Cylinder Kit Includes			
HP 111656	2882631	Piston	1
HP 111089	4923748	Pin	1
111171	3064305	Retainers	2
HP 505175	2881682	Ring Set	1
161655	4376168	Liner Kit	1





PAI CUMMINS ENGINE KITS

ISO 9001 CERTIFIED

HP PART(S) AVAILABLE IN STANDARD AND HIGH PERFORMANCE

ISX SERIES

ISX106-128-144 INFRAME KIT EGR ENGINE			
PAI Ref.	OEM Ref.	Description	Qty.
HP 171980	3800298	Main Bearing Kit	1
172045	2882087	Fractured Rod Bearings	6 prs
131638	4955596	Upper Gasket Kit	1
131838	N/A	Pan Gasket Kit	1
050504	4920586	Fuel Filter	1
050514	4367100	Oil Filter	1
180240	4357177	Oil Relief Valve	1
101203	N/A	Cylinder Kits	6
Cylinder Kit Includes			
111656	2882631	Piston	1
HP 111089	4923748	Pin	1
111171	3064305	Retainers	2
HP 505175	4309441	Ring Set	1
161658	4376391	Liner Kit	1
Liner Kit Includes			
161654	3690557	Liner	1
121311	3678738	Seal	1
162030	5298565	Shim	1
161996	3689871	Anti-Polishing Ring	1

ISX SERIES

HP ISX107-017-080 INFRAME KIT EGR ENGINE			
PAI Ref.	OEM Ref.	Description	Qty.
HP 171980	3800298	Main Bearing Kit	1
HP 171990	4089405	Rod Bearings	6 prs
131638	4955596	Upper Gasket Kit	1
131838	N/A	Pan Gasket Kit	1
101177	N/A	Cylinder Kits	6
101178	N/A		
101179	N/A		
Cylinder Kit Includes			
HP 111659	2882630	Piston	1
HP 111089	4923748	Pin	1
111171	3064305	Retainers	2
HP 505175	4309441	Ring Set	1
161647	4089153	Liner Kit	1
161649	2881719		
161651	4309389		

(P) = PREMIUM • (P+)=PREMIUM PLUS • (E)=EARLY STYLE SLEEVE KITS • (C)=CURRENT STYLE SLEEVE KITS
KITS ARE AVAILABLE WITH OVERSIZED LINERS & BEARINGS (CALL TECHNICAL SUPPORT FOR DASH #'s)

Please note: Specify size of Rod Bearings and Main Bearings when ordering Rebuild Kits. All OEM references shown are examples of standard sizes. Other sizes are available. Please call for correct dash number for application. **MUST VERIFY BY SERIAL AND ARRANGEMENT.**



PAI CUMMINS ENGINE KITS

ISO 9001 CERTIFIED

HP PART(S) AVAILABLE IN STANDARD AND HIGH PERFORMANCE

ISX SERIES

HP ISX107-081-096 INFRAME KIT EGR ENGINE			
PAI Ref.	OEM Ref.	Description	Qty.
HP 171980	3800298	Main Bearing Kit	1
HP 171990	4089405	Rod Bearings	6 prs
131638	4955596	Upper Gasket Kit	1
131838	N/A	Pan Gasket Kit	1
101179	N/A	Cylinder Kits	6
Cylinder Kit Includes			
HP 111659	2882630	Piston	1
HP 111089	4923748	Pin	1
111171	3064305	Retainers	2
HP 505175	4309441	Ring Set	1
161651	4309389	Liner Kit	1

ISX SERIES

HP ISX107-097-112 INFRAME KIT PRE-EGR ENGINE			
PAI Ref.	OEM Ref.	Description	Qty.
HP 171980	3800298	Main Bearing Kit	1
HP 171990	4089405	Rod Bearings	6 prs
131637	4955595	Upper Gasket Kit	1
131838	N/A	Pan Gasket Kit	1
101179	N/A	Cylinder Kits	6
Cylinder Kit Includes			
HP 111659	2882630	Piston	1
HP 111089	4923748	Pin	1
111171	3064305	Retainers	2
HP 505175	4309441	Ring Set	1
161651	4309389	Liner Kit	1

ISX SERIES

ISX108-017-048 INFRAME KIT EGR ENGINE			
PAI Ref.	OEM Ref.	Description	Qty.
HP 171980	3800298	Main Bearing Kit	1
HP 171990	4089405	Rod Bearings	6 prs
131906	2881767	Upper Gasket Kit	1
131838	N/A	Pan Gasket Kit	1
101164	N/A	Cylinder Kits	6
Cylinder Kit Includes			
111730	3687897	Piston	1
HP 111089	4923748	Pin	1
111171	3064305	Retainers	2
505193	3685672	Ring Set	1
161649	2881719	Liner Kit	1

(P) = PREMIUM • (P+)=PREMIUM PLUS • (E)=EARLY STYLE SLEEVE KITS • (C)=CURRENT STYLE SLEEVE KITS
KITS ARE AVAILABLE WITH OVERSIZED LINERS & BEARINGS (CALL TECHNICAL SUPPORT FOR DASH #'s)

Please note: Specify size of Rod Bearings and Main Bearings when ordering Rebuild Kits. All OEM references shown are examples of standard sizes. Other sizes are available. Please call for correct dash number for application. **MUST VERIFY BY SERIAL AND ARRANGEMENT.**



PAI CUMMINS ENGINE KITS

ISO 9001 CERTIFIED

HP PART(S) AVAILABLE IN STANDARD AND HIGH PERFORMANCE

ISX SERIES

ISX SERIES

ISX108-049-080 INFRAME KIT EGR ENGINE

PAI Ref.	OEM Ref.	Description	Qty.
HP 171980	3800298	Main Bearing Kit	1
172045	2882087	Rod Bearings	6 prs
131906	2881767	Upper Gasket Kit	1
131838	N/A	Pan Gasket Kit	1
050514	4367100	Oil Filter	1
180240	4357177	Oil Bypass Plunger	1
101216	N/A	Cylinder Kits	6
Cylinder Kit Includes			
111730	3687897	Piston	1
HP 111089	4923748	Pin	1
111171	3064305	Retainers	2
505193	3685672	Ring Set	1
161649	2881719	Liner Kit	1
Liner Kit Includes			
161657	4373362	Liner	1
162030	5298565	Shim	1
121400	3685234	Seal	1
161996	3689871	Anti-Polishing Ring	1

ISX108-081-096 INFRAME KIT EGR ENGINE

PAI Ref.	OEM Ref.	Description	Qty.
HP 171980	3800298	Main Bearing Kit	1
HP 171990	4089405	Rod Bearings	6 prs
131906	2881767	Upper Gasket Kit	1
131838	N/A	Pan Gasket Kit	1
101197	N/A	Cylinder Kits	6
Cylinder Kit Includes			
111730	3687897	Piston	1
HP 111089	4923748	Pin	1
111171	3064305	Retainers	2
505193	3685672	Ring Set	1
161655	4376168	Liner Kit	1
Liner Kit Includes			
161654	3690557	Liner	1
121311	3678738	Seal	1
161996	3689871	Anti-Polishing Ring	1

(P) = PREMIUM • (P+)=PREMIUM PLUS • (E)=EARLY STYLE SLEEVE KITS • (C)=CURRENT STYLE SLEEVE KITS
KITS ARE AVAILABLE WITH OVERSIZED LINERS & BEARINGS (CALL TECHNICAL SUPPORT FOR DASH #'s)

Please note: Specify size of Rod Bearings and Main Bearings when ordering Rebuild Kits. All OEM references shown are examples of standard sizes. Other sizes are available. Please call for correct dash number for application. **MUST VERIFY BY SERIAL AND ARRANGEMENT.**



PAI CUMMINS ENGINE KITS

ISO 9001 CERTIFIED

HP PART(S) AVAILABLE IN STANDARD AND HIGH PERFORMANCE

ISX SERIES

ISX108-097-112 INFRAME KIT EGR ENGINE			
PAI Ref.	OEM Ref.	Description	Qty.
HP 171980	3800298	Main Bearing Kit	1
172045	2882087	Rod Bearings	6 prs
131906	2881767	Upper Gasket Kit	1
131838	N/A	Pan Gasket Kit	1
050506	2893612	Fuel Filter	1
050514	4367100	Oil Filter	1
180240	4357177	Oil Bypass Plunger	1
101197	N/A	Cylinder Kits	6
Cylinder Kit Includes			
111730	3687897	Piston	1
HP 111089	4923748	Pin	1
111171	3064305	Retainers	2
505193	3685672	Ring Set	1
161655	4376168	Liner Kit	1

ISX SERIES

ISX110-017-048 INFRAME KIT EGR ENGINE			
PAI Ref.	OEM Ref.	Description	Qty.
HP 171980	3800298	Main Bearing Kit	1
HP 171990	4089405	Rod Bearings	6 prs
131638	4955596	Upper Gasket Kit	1
131838	N/A	Pan Gasket Kit	1
101194	N/A	Cylinder Kits	6
Cylinder Kit Includes			
111653	2882636	Piston	1
HP 111089	4923748	Pin	1
111171	3064305	Retainers	2
HP 505175	2881682	Ring Set	1
161647	4089153	Liner Kit	1

ISX SERIES

ISX110-049-080 INFRAME KIT EGR ENGINE			
PAI Ref.	OEM Ref.	Description	Qty.
HP 171980	3800298	Main Bearing Kit	1
HP 171990	4089405	Rod Bearings	6 prs
131637	4955595	Upper Gasket Kit	1
131638	4955596		
131838	N/A	Pan Gasket Kit	1
101194	N/A	Cylinder Kits	6
Cylinder Kit Includes			
111653	2882636	Piston	1
HP 111089	4923748	Pin	1
111171	3064305	Retainers	2
HP 505175	2881682	Ring Set	1
161647	4089153	Liner Kit	1

(P) = PREMIUM • (P+)=PREMIUM PLUS • (E)=EARLY STYLE SLEEVE KITS • (C)=CURRENT STYLE SLEEVE KITS
KITS ARE AVAILABLE WITH OVERSIZED LINERS & BEARINGS (CALL TECHNICAL SUPPORT FOR DASH #'s)

Please note: Specify size of Rod Bearings and Main Bearings when ordering Rebuild Kits. All OEM references shown are examples of standard sizes. Other sizes are available. Please call for correct dash number for application. **MUST VERIFY BY SERIAL AND ARRANGEMENT.**



PAI CUMMINS ENGINE KITS

ISO 9001 CERTIFIED

HP PART(S) AVAILABLE IN STANDARD AND HIGH PERFORMANCE

ISX SERIES

ISX110-081-096 INFRAME KIT PRE-EGR ENGINE

PAI Ref.	OEM Ref.	Description	Qty.
HP 171980	3800298	Main Bearing Kit	1
HP 171990	4089405	Rod Bearings	6 prs
131637	4955595	Upper Gasket Kit	1
131838	N/A	Pan Gasket Kit	1
101196	N/A	Cylinder Kits	6
Cylinder Kit Includes			
111653	2882636	Piston	1
HP 111089	4923748	Pin	1
111171	3064305	Retainers	2
HP 505175	2881682	Ring Set	1
161651	4309389	Liner Kit	1

ISX SERIES

ISX110-097-112 INFRAME KIT PRE-EGR ENGINE

PAI Ref.	OEM Ref.	Description	Qty.
HP 171980	3800298	Main Bearing Kit	1
HP 171990	4089405	Rod Bearings	6 prs
131637	4955595	Upper Gasket Kit	1
131838	N/A	Pan Gasket Kit	1
141307	3820320	Oil Bypass Plunger	1
101196	N/A	Cylinder Kits	6
Cylinder Kit Includes			
111653	2882636	Piston	1
HP 111089	4923748	Pin	1
111171	3064305	Retainers	2
HP 505175	2881682	Ring Set	1
161651	4309389	Liner Kit	1

(P) = PREMIUM • (P+)=PREMIUM PLUS • (E)=EARLY STYLE SLEEVE KITS • (C)=CURRENT STYLE SLEEVE KITS
KITS ARE AVAILABLE WITH OVERSIZED LINERS & BEARINGS (CALL TECHNICAL SUPPORT FOR DASH #'s)

Please note: Specify size of Rod Bearings and Main Bearings when ordering Rebuild Kits. All OEM references shown are examples of standard sizes. Other sizes are available. Please call for correct dash number for application. **MUST VERIFY BY SERIAL AND ARRANGEMENT.**



PAI CUMMINS ENGINE KITS

ISO 9001 CERTIFIED

HP PART(S) AVAILABLE IN STANDARD AND HIGH PERFORMANCE

ISX SERIES

ISX110-113-128 INFRAME KIT PRE-EGR ENGINE			
PAI Ref.	OEM Ref.	Description	Qty.
HP 171980	3800298	Main Bearing Kit	1
172045	2882087	Rod Bearings	6 prs
131637	4955595	Upper Gasket Kit	1
131838	N/A	Pan Gasket Kit	1
050504	4920586	Fuel Filter	1
050514	4367100	Oil Filter	1
180240	4357177	Oil Relief Valve	1
101201	N/A	Cylinder Kits	6
Cylinder Kit Includes			
111653	2882636	Piston	1
HP 111089	4923748	Pin	1
111171	3064305	Retainers	2
HP 505175	2881682	Ring Set	1
161651	4309389	Liner Kit	1
Liner Kit Includes			
161654	3690557	Liner	1
121311	3678738	Seal	1
161996	3689871	Anti-Polishing Ring	1

ISX SERIES

ISX111-017-048 INFRAME KIT			
PAI Ref.	OEM Ref.	Description	Qty.
HP 171980	3800298	Main Bearing Kit	1
HP 171990	4089405	Rod Bearings	6 prs
172045	2882087		
131906	2881767	Upper Gasket Kit	1
131838	N/A	Pan Gasket Kit	1
101180	N/A	Cylinder Kits	6
Cylinder Kit Includes			
111733	3688099	Piston	1
HP 111089	4923748	Pin	1
111171	3064305	Retainers	2
505179	4376565	Ring Set	1
161655	4376168	Liner Kit	1

ISX111-049-080 INFRAME KIT			
PAI Ref.	OEM Ref.	Description	Qty.
HP 171980	3800298	Main Bearing Kit	1
HP 171990	4089405	Rod Bearings	6 prs
172045	2882087		
131906	2881767	Upper Gasket Kit	1
131838	N/A	Pan Gasket Kit	1
101198	N/A	Cylinder Kits	6
Cylinder Kit Includes			
111733	3688099	Piston	1
HP 111089	4923748	Pin	1
111171	3064305	Retainers	2
HP 505175	4309441	Ring Set	1
161658	4376391	Liner Kit	1
Liner Kit Includes			
161657	4373362	Liner	1
121400	3685234	Seal	1
162030	5298565	Shim	1
161996	3689871	Anti-Polishing Ring	1



PAI CUMMINS ENGINE KITS

ISO 9001 CERTIFIED

HP PART(S) AVAILABLE IN STANDARD AND HIGH PERFORMANCE

ISX SERIES

ISX SERIES

ISX111-081-096 INFRAME KIT			
PAI Ref.	OEM Ref.	Description	Qty.
HP 171980	3800298	Main Bearing Kit	1
171990	4089405	Rod Bearings	6 prs
131906	2881767	Upper Gasket Kit	1
131838	N/A	Pan Gasket Kit	1
141307	3820320	Oil Bypass Plunger	1
101214	N/A	Cylinder Kits	6
Cylinder Kit Includes			
111733	3688099	Piston	1
HP 111089	4923748	Pin	1
111171	3064305	Retainers	2
HP 505175	4309441	Ring Set	1
161651	4309389	Liner Kit	1

ISX111-097-112 INFRAME KIT w/ Anti-Polishing Ring			
PAI Ref.	OEM Ref.	Description	Qty.
HP 171980	3800298	Main Bearing Kit	1
172045	2882087	Rod Bearings	6 prs
131906	2881767	Upper Gasket Kit	1
131838	N/A	Pan Gasket Kit	1
050506	2893612	Fuel Filter	1
050514	4367100	Oil Filter	1
180240	4357177	Oil Bypass Plunger	1
101198	N/A	Cylinder Kits	6
Cylinder Kit Includes			
111733	3688099	Piston	1
HP 111089	4923748	Pin	1
111171	3064305	Retainers	2
HP 505175	4309441	Ring Set	1
161658	4376391	Liner Kit	1

ISX111-113-128 INFRAME KIT w/ Anti-Polishing Ring			
PAI Ref.	OEM Ref.	Description	Qty.
HP 171980	3800298	Main Bearing Kit	1
171990	4089405	Rod Bearings	6 prs
131906	2881767	Upper Gasket Kit	1
131838	N/A	Pan Gasket Kit	1
141307	3820320	Oil Bypass Plunger	1
101215	N/A	Cylinder Kits	6
Cylinder Kit Includes			
111733	3688099	Piston	1
HP 111089	4923748	Pin	1
111171	3064305	Retainers	2
HP 505175	4309441	Ring Set	1
161649	2881719	Liner Kit	1



PAI CUMMINS ENGINE KITS

ISO 9001 CERTIFIED

HP PART(S) AVAILABLE IN STANDARD AND HIGH PERFORMANCE

ISX SERIES

ISX112-(*) INFRAME KIT			
PAI Ref.	OEM Ref.	Description	Qty.
HP 171980	3800298	Main Bearing Kit	1
172045	2882087	Rod Bearings	6 prs
131637	4955595	Upper Gasket Kit	1
131838	N/A	Pan Gasket Kit	1
050524	3331096	Fuel/Water Filter	1
050514	4367100	Oil Filter	1
180240	4357177	Oil Bypass Plunger	1
101202	N/A	Cylinder Kits	6
Cylinder Kit Includes			
111763	4367132	Piston	1
HP 111089	4923748	Pin	1
111171	3064305	Retainers	2
HP 505175	2881682	Ring Set	1
161655	4376168	Liner Kit	1

ISX SERIES

ISX113-(*) INFRAME KIT EGR ENGINE			
PAI Ref.	OEM Ref.	Description	Qty.
HP 171980	3800298	Main Bearing Kit	1
172045	2882087	Rod Bearings	6 prs
131637	4955595	Upper Gasket Kit	1
131838	N/A	Pan Gasket Kit	1
050504	4920586	Fuel/Water Filter Separator	1
050514	4367100	Oil Filter	1
180240	4357177	Bypass Plunger	1
101204	N/A	Cylinder Kits	6
Cylinder Kit Includes			
111763	4367132	Piston	1
HP 111089	4923748	Pin	1
111171	3064305	Retainers	2
HP 505175	4309441	Ring Set	1
161655	4376168	Liner Kit	1

(P) = PREMIUM • (P+)=PREMIUM PLUS • (E)=EARLY STYLE SLEEVE KITS • (C)=CURRENT STYLE SLEEVE KITS
KITS ARE AVAILABLE WITH OVERSIZED LINERS & BEARINGS (CALL TECHNICAL SUPPORT FOR DASH #'s)

Please note: Specify size of Rod Bearings and Main Bearings when ordering Rebuild Kits. All OEM references shown are examples of standard sizes. Other sizes are available. Please call for correct dash number for application. **MUST VERIFY BY SERIAL AND ARRANGEMENT.**



PAI CUMMINS ENGINE KITS

ISO 9001 CERTIFIED

HP PART(S) AVAILABLE IN STANDARD AND HIGH PERFORMANCE

ISX SERIES

ISX SERIES

ISX-114(*) INFRAME KIT EGR ENGINE			
PAI Ref.	OEM Ref.	Description	Qty.
HP 171980	3800298	Main Bearing Kit	1
HP 171990	4089405	Rod Bearings	6 prs
131638	4955596	Upper Gasket Kit	1
131838	N/A	Pan Gasket Kit	1
141307	3820320	Bypass Plunger	1
101207	N/A	Cylinder Kits	6
Cylinder Kit Includes			
111746	4298991	Piston	1
HP 111089	4923748	Pin	1
111171	3064305	Retainers	2
HP 505175	4309441	Ring Set	1
161651	4309389	Liner Kit	1

ISX115-(*) INFRAME KIT EGR ENGINE			
PAI Ref.	OEM Ref.	Description	Qty.
HP 171980	3800298	Main Bearing Kit	1
172045	2882087	Rod Bearings	6 prs
131638	4955596	Upper Gasket Kit	1
131838	N/A	Pan Gasket Kit	1
050504	4920586	Fuel/Water Filter Separator	1
050514	4367100	Oil Filter	1
180240	4357177	Bypass Plunger	1
101208	N/A	Cylinder Kits	6
Cylinder Kit Includes			
111737	4357149	Piston	1
HP 111089	4923748	Pin	1
111171	3064305	Retainers	2
HP 505175	4309441	Ring Set	1
161655	4376168	Liner Kit	1

(P) = PREMIUM • (P+)=PREMIUM PLUS • (E)=EARLY STYLE SLEEVE KITS • (C)=CURRENT STYLE SLEEVE KITS
KITS ARE AVAILABLE WITH OVERSIZED LINERS & BEARINGS (CALL TECHNICAL SUPPORT FOR DASH #'s)

Please note: Specify size of Rod Bearings and Main Bearings when ordering Rebuild Kits. All OEM references shown are examples of standard sizes. Other sizes are available. Please call for correct dash number for application. **MUST VERIFY BY SERIAL AND ARRANGEMENT.**



PAI CUMMINS ENGINE KITS

ISO 9001 CERTIFIED

HP PART(S) AVAILABLE IN STANDARD AND HIGH PERFORMANCE

ISX SERIES

ISX SERIES

ISX116-113-128 INFRAME KIT			
PAI Ref.	OEM Ref.	Description	Qty.
HP 171980	3800298	Main Bearing Kit	1
172045	2882087	Rod Bearings	6 prs
131637	4955595	Upper Gasket Kit	1
131838	N/A	Pan Gasket Kit	1
050524	3331096	Fuel/Water Filter Separator	1
050514	4367100	Oil Filter	1
180240	4357177	Oil Bypass Plunger	1
101210	N/A	Cylinder Kits	6
Cylinder Kit Includes			
111772	4357150	Piston	1
HP 111089	4923748	Pin	1
111171	3064305	Retainers	2
HP 505175	4309441	Ring Set	1
161655	4376168	Liner Kit	1

ISX116-129-144 INFRAME KIT			
PAI Ref.	OEM Ref.	Description	Qty.
HP 171980	3800298	Main Bearing Kit	1
172045	2882087	Rod Bearings	6 prs
131637	4955595	Upper Gasket Kit	1
131838	N/A	Pan Gasket Kit	1
050524	3331096	Fuel/Water Filter Separator	1
050514	4367100	Oil Filter	1
180240	4357177	Oil Bypass Plunger	1
101209	N/A	Cylinder Kits	6
Cylinder Kit Includes			
111772	4357150	Piston	1
HP 111089	4923748	Pin	1
111171	3064305	Retainers	2
HP 505175	4309441	Ring Set	1
161658	4376391	Liner Kit	1

(P) = PREMIUM • (P+)=PREMIUM PLUS • (E)=EARLY STYLE SLEEVE KITS • (C)=CURRENT STYLE SLEEVE KITS
 KITS ARE AVAILABLE WITH OVERSIZED LINERS & BEARINGS (CALL TECHNICAL SUPPORT FOR DASH #'s)

Please note: Specify size of Rod Bearings and Main Bearings when ordering Rebuild Kits. All OEM references shown are examples of standard sizes. Other sizes are available. Please call for correct dash number for application. **MUST VERIFY BY SERIAL AND ARRANGEMENT.**



PAI CUMMINS ENGINE KITS

ISO 9001 CERTIFIED

HP PART(S) AVAILABLE IN STANDARD AND HIGH PERFORMANCE

ISX SERIES

ISX SERIES

ISX117-113-128 INFRAME KIT

PAI Ref.	OEM Ref.	Description	Qty.
HP 171980	3800298	Main Bearing Kit	1
172045	2882087	Rod Bearings	6 prs
131637	4955595	Upper Gasket Kit	1
131838	N/A	Pan Gasket Kit	1
050504	4920586	Fuel/Water Filter Separator	1
050514	4367100	Oil Filter	1
180240	4357177	Oil Bypass Plunger	1
101211	N/A	Cylinder Kits	6
Cylinder Kit Includes			
111775	4367126	Piston	1
HP 111089	4923748	Pin	1
111171	3064305	Retainers	2
HP 505175	4309441	Ring Set	1
161655	4376168	Liner Kit	1

ISX118-017-032 INFRAME KIT

PAI Ref.	OEM Ref.	Description	Qty.
HP 171980	3800298	Main Bearing Kit	1
HP 171990	4089405	Rod Bearings	6 prs
131638	4955596	Upper Gasket Kit	1
131838	N/A	Pan Gasket Kit	1
050504	4920586	Fuel/Water Filter Separator	1
050514	4367100	Oil Filter	1
180240	4357177	Oil Bypass Plunger	1
101212	N/A	Cylinder Kits	6
Cylinder Kit Includes			
111769	4367173	Piston	1
HP 111089	4923748	Pin	1
111171	3064305	Retainers	2
HP 505175	4309441	Ring Set	1
161655	4376168	Liner Kit	1

(P) = PREMIUM • (P+)=PREMIUM PLUS • (E)=EARLY STYLE SLEEVE KITS • (C)=CURRENT STYLE SLEEVE KITS
 KITS ARE AVAILABLE WITH OVERSIZED LINERS & BEARINGS (CALL TECHNICAL SUPPORT FOR DASH #'s)

Please note: Specify size of Rod Bearings and Main Bearings when ordering Rebuild Kits. All OEM references shown are examples of standard sizes. Other sizes are available. Please call for correct dash number for application. **MUST VERIFY BY SERIAL AND ARRANGEMENT.**



PAI CUMMINS ENGINE KITS

ISO 9001 CERTIFIED

HP PART(S) AVAILABLE IN STANDARD AND HIGH PERFORMANCE

ISX SERIES

ISX SERIES

ISX118-129-144 INFRAME KIT			
PAI Ref.	OEM Ref.	Description	Qty.
HP 171980	3800298	Main Bearing Kit	1
172045	2882087	Rod Bearings	6 prs
131638	4955596	Upper Gasket Kit	1
131838	N/A	Pan Gasket Kit	1
050504	4920586	Fuel/Water Filter Separator	1
050514	4367100	Oil Filter	1
180240	4357177	Oil Bypass Plunger	1
101203	N/A	Cylinder Kits	6
Cylinder Kit Includes			
111769	4367173	Piston	1
HP 111089	4923748	Pin	1
111171	3064305	Retainers	2
HP 505175	4309441	Ring Set	1
161658	4376391	Liner Kit	1

ISX121-(*) INFRAME KIT DRILLED & NON-DRILLED RODS			
PAI Ref.	OEM Ref.	Description	Qty.
HP 171980	3800298	Main Bearing Kit	1
HP 171970	4089139	Rod Bearings	6 prs
HP 171990	4089405		
131637	4955595	Upper Gasket Kit	1
131656	4026684	Pan Gasket Kit	1
101168	N/A	Cylinder Kits	6
Cylinder Kit Includes			
111490	4059344	Piston	1
111090	3678590	Pin	1
111171	3064305	Retainers	2
505120	4089154	Ring Set	1
161647	4089153	Liner Kit	1

(P) = PREMIUM • (P+)=PREMIUM PLUS • (E)=EARLY STYLE SLEEVE KITS • (C)=CURRENT STYLE SLEEVE KITS
KITS ARE AVAILABLE WITH OVERSIZED LINERS & BEARINGS (CALL TECHNICAL SUPPORT FOR DASH #'s)

Please note: Specify size of Rod Bearings and Main Bearings when ordering Rebuild Kits. All OEM references shown are examples of standard sizes. Other sizes are available. Please call for correct dash number for application. **MUST VERIFY BY SERIAL AND ARRANGEMENT.**



PAI CUMMINS ENGINE KITS

ISO 9001 CERTIFIED

HP PART(S) AVAILABLE IN STANDARD AND HIGH PERFORMANCE

ISX SERIES

ISX SERIES

HP ISX140-(*) INFRAME KITS PISTONLESS

PAI Ref.	OEM Ref.	Description	Qty.
HP 171980	3800298	Main Bearing Kit	1
HP 171970	4089139	Rod Bearings	6 prs
HP 171990	4089405		
121308	3678756	Oil Pan O-Ring	1
131656	4026684	Oil Pan Gasket	1
131637	4955595	Upper Gasket Kit	1
131638	4955596		
HP 111089	4923748	Pins	6
111090	3678590		
111171	3064305	Retainers	12
HP 505125	4089406	Ring Sets	6
505120	4089154		
161647	4089153	Liner Kits	6

HP ISX141-(*) INFRAME KITS PISTONLESS

PAI Ref.	OEM Ref.	Description	Qty.
HP 171980	3800298	Main Bearing Kit	1
HP 171990	4089405	Rod Bearings	6 prs
121308	3678756	Oil Pan O-Ring	1
131656	4026684	Oil Pan Gasket	1
131637	4955595	Upper Gasket Kit	1
131638	4955596		
HP 111089	4923748	Pins	6
111171	3064305	Retainers	12
HP 505125	4089406	Ring Sets	6
161647	4089153	Liner Kits	6

(P) = PREMIUM • (P+)=PREMIUM PLUS • (E)=EARLY STYLE SLEEVE KITS • (C)=CURRENT STYLE SLEEVE KITS
KITS ARE AVAILABLE WITH OVERSIZED LINERS & BEARINGS (CALL TECHNICAL SUPPORT FOR DASH #'s)

Please note: Specify size of Rod Bearings and Main Bearings when ordering Rebuild Kits. All OEM references shown are examples of standard sizes. Other sizes are available. Please call for correct dash number for application. **MUST VERIFY BY SERIAL AND ARRANGEMENT.**



PAI CUMMINS ENGINE KITS

ISO 9001 CERTIFIED

HP PART(S) AVAILABLE IN STANDARD AND HIGH PERFORMANCE

L10 SERIES

L10101-(*) INFRAME KIT			
PAI Ref.	OEM Ref.	Description	Qty.
HP 171725	3801150	Main Bearing Kit	1
HP 171866	4025120		
HP 171780	3016760	Rod Bearings	12 pcs
131265	4025155	Upper Gasket Kit	1
131482	4089478		
131492	N/A	Pan Gasket Kit	1
131493	N/A		
131268	3034855	Valve Cover Gasket	1
101061	3803632	Cylinder Kits	6
Cylinder Kit Includes			
111177	3044448	Piston	1
111174	3016650	Pin	1
111178	3016652	Retainers	2
505060	3803961	Ring Set	1
161626	3803703	Liner Kit	1

L10 SERIES

L10102-(*) INFRAME KIT			
PAI Ref.	OEM Ref.	Description	Qty.
HP 171725	3801150	Main Bearing Kit	1
HP 171866	4025120		
HP 171780	3016760	Rod Bearings	12 pcs
131265	4025155	Upper Gasket Kit	1
131492	N/A	Pan Gasket Kit	1
131268	3034855	Valve Cover Gasket	1
101060	3803633	Cylinder Kits	6
Cylinder Kit Includes			
111175	3045907	Piston	1
111174	3016650	Pin	1
111178	3016652	Retainers	2
505060	3803961	Ring Set	1
161626	3803703	Liner Kit	1

L10 SERIES

L10 SERIES

L10103-(*) INFRAME KIT			
PAI Ref.	OEM Ref.	Description	Qty.
HP 171725	3801150	Main Bearing Kit	1
HP 171866	4025120		
HP 171780	3016760	Rod Bearings	12 pcs
131265	4025155	Upper Gasket Kit	1
131492	N/A	Pan Gasket Kit	1
131268	3034855	Valve Cover Gasket	1
101062	3803629	Cylinder Kits	6
Cylinder Kit Includes			
111179	3055622	Piston	1
111174	3016650	Pin	1
111178	3016652	Retainers	2
505060	3803961	Ring Set	1
161626	3803703	Liner Kit	1

L10123-(*) INFRAME KIT

PAI Ref.	OEM Ref.	Description	Qty.
HP 171725	3801150	Main Bearing Kit	1
HP 171866	4025120		
HP 171780	3016760	Rod Bearings	12 pcs
131540	N/A	Upper Gasket Kit	1
131493	N/A	Pan Gasket Kit	1
131268	3034855	Valve Cover Gasket	1
131496	3883220		
101062	3803629	Cylinder Kits	6
Cylinder Kit Includes			
111179	3055622	Piston	1
111174	3016650	Pin	1
111178	3016652	Retainers	2
505060	3803961	Ring Set	1
161626	3803703	Liner Kit	1



PAI CUMMINS ENGINE KITS

ISO 9001 CERTIFIED

HP PART(S) AVAILABLE IN STANDARD AND HIGH PERFORMANCE

L10 SERIES

L10124-(*) INFRAME KIT			
PAI Ref.	OEM Ref.	Description	Qty.
HP 171725	3801150	Main Bearing Kit	1
HP 171866	4025120		
HP 171780	3016760	Rod Bearings	12 pcs
131540	N/A	Upper Gasket Kit	1
131493	N/A	Pan Gasket Kit	1
131268	3034855	Valve Cover Gasket	1
131496	3883220		
101067	3803623	Cylinder Kits	6
Cylinder Kit Includes			
111361	3068090	Piston	1
111092	3063843	Pin	1
111178	3016652	Retainers	2
505060	3803961	Ring Set	1
161626	3803703	Liner Kit	1

L10 SERIES

L10125-(*) INFRAME KIT			
PAI Ref.	OEM Ref.	Description	Qty.
HP 171725	3801150	Main Bearing Kit	1
HP 171866	4025120		
HP 171780	3016760	Rod Bearings	12 pcs
131540	N/A	Upper Gasket	1
131493	N/A	Pan Gasket Kit	1
131268	3034855	Valve Cover Gasket	1
131496	3883220		
101068	3803963	Cylinder Kits	6
Cylinder Kit Includes			
111365	3893751	Piston	1
111092	3063843	Pin	1
111178	3016652	Retainers	2
505060	3803961	Ring Set	1
161626	3803703	Liner Kit	1

(P) = PREMIUM • (P+)=PREMIUM PLUS • (E)=EARLY STYLE SLEEVE KITS • (C)=CURRENT STYLE SLEEVE KITS
 KITS ARE AVAILABLE WITH OVERSIZED LINERS & BEARINGS (CALL TECHNICAL SUPPORT FOR DASH #'s)

Please note: Specify size of Rod Bearings and Main Bearings when ordering Rebuild Kits. All OEM references shown are examples of standard sizes. Other sizes are available. Please call for correct dash number for application. **MUST VERIFY BY SERIAL AND ARRANGEMENT.**



PAI CUMMINS ENGINE KITS

ISO 9001 CERTIFIED

HP PART(S) AVAILABLE IN STANDARD AND HIGH PERFORMANCE

L10 SERIES

L10126-(*) INFRAME KIT			
PAI Ref.	OEM Ref.	Description	Qty.
HP 171725	3801150	Main Bearing Kit	1
HP 171866	4025120		
HP 171780	3016760	Rod Bearings	12 pcs
131482	4089478	Upper Gasket Kit	1
131493	N/A	Pan Gasket Kit	1
101090	4025167	Cylinder Kits	6
Cylinder Kit Includes			
111370	3074108	Crown	1
111371	3067804	Skirt	1
111092	3063843	Pins	2
111178	3016652	Retainers	2
505060	3803961	Ring Set	1
161626	3803703	Liner Kit	1

L10 SERIES

L10127-(*) INFRAME KIT CROWNLESS			
PAI Ref.	OEM Ref.	Description	Qty.
HP 171725	3801150	Main Bearing Kit	1
HP 171866	4025120		
HP 171780	3016760	Rod Bearings	12 pcs
131482	4089478	Upper Gasket Kit	1
131493	N/A	Pan Gasket Kit	1
505060	3803961	Ring Sets	6
161626	3803703	Liner Kits	6
Piston Components Includes			
111371	3067804	Skirt	1
111092	3063843	Pin	1
111178	3016652	Retainers	2

L10 SERIES

L10128-(*) INFRAME KIT NATURAL GAS			
PAI Ref.	OEM Ref.	Description	Qty.
HP 171725	3801150	Main Bearing Kit	1
HP 171866	4025120		
HP 171780	3016760	Rod Bearings	12 pcs
131265	4025155	Upper Gasket Kit	1
131482	4089478		
131492	N/A	Pan Gasket Kit	1
131493	N/A		
131268	3034855	Valve Cover Gasket	1
101183	3804696	Cylinder Kits	6
Cylinder Kit Includes			
111598	3606677	Piston	1
111174	3016650	Pin	1
111178	3016652	Retainers	2
505051	3804694	Ring Set	1
161626	3803703	Liner Kit	1



PAI CUMMINS ENGINE KITS

ISO 9001 CERTIFIED

HP PART(S) AVAILABLE IN STANDARD AND HIGH PERFORMANCE

M11 SERIES

M1127-(*) INFRAME KIT CROWNLESS			
PAI Ref.	OEM Ref.	Description	Qty.
HP 171725	3801150	Main Bearing Kit	1
HP 171866	4025120		
HP 171780	3016760	Rod Bearings	12 pcs
131482	4025157	Upper Gasket Kit	1
131493	N/A	Pan Gasket Kit	1
101150	N/A	Cylinder Kits	6
Cylinder Kit Includes			
HP 111391	4070653	Skirt	1
HP 111092	3063843	Pin	1
111178	3016652	Retainers	2
HP 505100	3803977	Ring Set	1
161626	3803703	Liner Kit	1

M11 SERIES

HP M11201-(*) INFRAME KIT			
PAI Ref.	OEM Ref.	Description	Qty.
HP 171725	3801150	Main Bearing Kit	1
HP 171866	4025120		
HP 171780	3016760	Rod Bearings	12 pcs
131482	4025157	Upper Gasket Kit	1
131493	N/A	Pan Gasket Kit	1
HP 101106	4025162	Cylinder Kits	6
Cylinder Kit Includes			
HP 111390	4059902	Crown	1
HP 111391	4070653	Skirt	1
HP 111092	3063843	Pin	1
111178	3016652	Retainers	2
HP 505100	3803977	Ring Set	1
161626	3803703	Liner Kit	1

PAI MANUFACTURING IN THE UNITED STATES SINCE 1973

(P) = PREMIUM • (P+)=PREMIUM PLUS • (E)=EARLY STYLE SLEEVE KITS • (C)=CURRENT STYLE SLEEVE KITS
 KITS ARE AVAILABLE WITH OVERSIZED LINERS & BEARINGS (CALL TECHNICAL SUPPORT FOR DASH #'s)

Please note: Specify size of Rod Bearings and Main Bearings when ordering Rebuild Kits. All OEM references shown are examples of standard sizes. Other sizes are available. Please call for correct dash number for application. **MUST VERIFY BY SERIAL AND ARRANGEMENT.**



PAI CUMMINS ENGINE KITS

ISO 9001 CERTIFIED

HP PART(S) AVAILABLE IN STANDARD AND HIGH PERFORMANCE

ISM SERIES

HP ISM101-(*) INFRAME KIT			
PAI Ref.	OEM Ref.	Description	Qty.
HP 171866	4025120	Main Bearing Kit	1
HP 171780	3016760	Rod Bearings	12 pcs
131482	4025157	Upper Gasket Kit	1
131493	N/A	Pan Gasket Kit	1
HP 101104	4025164	Cylinder Kits	6
Cylinder Kit Includes			
HP 111438	4059902	Crown	1
HP 111391	4070653	Skirt	1
HP 111092	3063843	Pin	1
111178	3016652	Retainers	2
HP 505100	3803977	Ring Set	1
161626	3803703	Liner Kit	1

ISM SERIES

HP ISM102-(*) INFRAME KIT			
PAI Ref.	OEM Ref.	Description	Qty.
HP 171866	4025120	Main Bearing Kit	1
HP 171780	3016760	Rod Bearings	12 pcs
131482	4025157	Upper Gasket Kit	1
131493	N/A	Pan Gasket Kit	1
HP 101107	N/A	Cylinder Kits	6
Cylinder Kit Includes			
HP 111583	3102807	Crown	1
HP 111391	4070653	Skirt	1
HP 111092	3063843	Pin	1
111178	3016652	Retainers	2
HP 505099	4089385	Ring Set	1
161628	4089388	Liner Kit	1

ISM SERIES

ISM103-(*) INFRAME KIT			
PAI Ref.	OEM Ref.	Description	Qty.
HP 171866	4025120	Main Bearing Kit	1
HP 171780	3016760	Rod Bearings	12 pcs
131482	4025157	Upper Gasket Kit	1
131493	N/A	Pan Gasket Kit	1
101108	N/A	Cylinder Kits	6
Cylinder Kit Includes			
111699	3103753	Crown	1
HP 111391	4070653	Skirt	1
HP 111092	3063843	Pin	1
111178	3016652	Retainers	2
HP 505100	3803977	Ring Set	1
161628	4089388	Liner Kit	1

ISM SERIES

ISM104-(*) INFRAME KIT			
PAI Ref.	OEM Ref.	Description	Qty.
HP 171866	4025120	Main Bearing Kit	1
HP 171780	3016760	Rod Bearings	12 pcs
131482	4089478	Upper Gasket Kit	1
131493	N/A	Pan Gasket Kit	1
101109	N/A	Cylinder Kits	6
Cylinder Kit Includes			
111695	4059948	Crown	1
HP 111391	4070653	Skirt	1
HP 111092	3063843	Pin	1
111178	3016652	Retainers	2
HP 505100	3803977	Ring Set	1
161628	4089388	Liner Kit	1

Please note: Specify size of Rod Bearings and Main Bearings when ordering Rebuild Kits. All OEM references shown are examples of standard sizes. Other sizes are available. Please call for correct dash number for application. **MUST VERIFY BY SERIAL AND ARRANGEMENT.**



PAI CUMMINS ENGINE KITS

ISO 9001 CERTIFIED

HP PART(S) AVAILABLE IN STANDARD AND HIGH PERFORMANCE

ISM SERIES

ISM139-(*) INFRAME KIT CROWNLESS EGR ENGINE			
PAI Ref.	OEM Ref.	Description	Qty.
HP 171866	4025120	Main Bearing Kit	1
HP 171780	3016760	Rod Bearings	12 pcs
131482	4025157	Upper Gasket Kit	1
131493	N/A	Pan Gasket Kit	1
HP 505099	4089385	Ring Sets	6
161628	4089388	Liner Kits	6
Piston Components Includes			
HP 111391	4070653	Skirts	6
HP 111092	3063843	Pins	6
111178	3016652	Retainers	12

ISM SERIES

ISM140-(*) INFRAME KIT PISTONLESS NON-EGR ENGINE			
PAI Ref.	OEM Ref.	Description	Qty.
HP 171866	4025120	Main Bearing Kit	1
HP 171780	3016760	Rod Bearings	12 pcs
131482	4025157	Upper Gasket Kit	1
131493	N/A	Pan Gasket Kit	1
HP 505100	3803977	Ring Sets	6
161626	3803703	Liner Kits	6

ISM SERIES

ISM140-(*) INFRAME KIT PISTONLESS EGR ENGINE			
PAI Ref.	OEM Ref.	Description	Qty.
HP 171866	4025120	Main Bearing Kit	1
HP 171780	3016760	Rod Bearings	12 pcs
131482	4025157	Upper Gasket Kit	1
131493	N/A	Pan Gasket Kit	1
HP 505099	4089385	Ring Sets	6
161628	4089388	Liner Kits	6

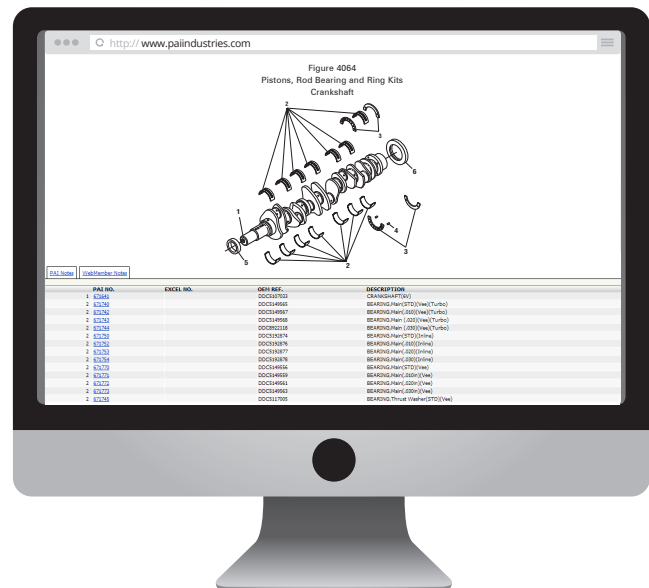

Search Millions of Parts Online

www.paiindustries.com

(P) = PREMIUM • (P+)=PREMIUM PLUS • (E)=EARLY STYLE SLEEVE KITS • (C)=CURRENT STYLE SLEEVE KITS
 KITS ARE AVAILABLE WITH OVERSIZED LINERS & BEARINGS (CALL TECHNICAL SUPPORT FOR DASH #'s)

Please note: Specify size of Rod Bearings and Main Bearings when ordering Rebuild Kits. All OEM references shown are examples of standard sizes. Other sizes are available. Please call for correct dash number for application. **MUST VERIFY BY SERIAL AND ARRANGEMENT.**



PAI CUMMINS ENGINE KITS

ISO 9001 CERTIFIED

HP PART(S) AVAILABLE IN STANDARD AND HIGH PERFORMANCE

4B SERIES

4BS101-(*) REBUILD KITS			
PAI Ref.	OEM Ref.	Description	Qty.
HP 171806	3802010	Main Bearing Kit	1
HP 171801	3901170	Machined Rod Bearings	8 pcs
HP 171952	N/A	Fractured Rod Bearings	4 prs
131401	3804896	Upper Gasket Kit	1
131402	3802375	Lower Gasket Kit	1
111217	3802060	Piston Kits	4
Piston Kit Includes			
111215	3906223	Piston	1
111208	3901793	Pin	1
111209	3901706	Retainers	2
505083	3802040	Ring Set	1

4B SERIES

4BS102-(*) REBUILD KITS			
PAI Ref.	OEM Ref.	Description	Qty.
HP 171806	3802010	Main Bearing Kit	1
HP 171801	3901170	Machined Rod Bearings	8 pcs
HP 171952	N/A	Fractured Rod Bearings	4 prs
131401	3804896	Upper Gasket Kit	1
131402	3802375	Lower Gasket Kit	1
111222	3802100	Piston Kits	4
Piston Kit Includes			
111220	3907156	Piston	1
111208	3901793	Pin	1
111209	3901706	Retainers	2
HP 505080	3802230	Ring Set	1

4B SERIES

4BS103-(*) REBUILD KITS			
PAI Ref.	OEM Ref.	Description	Qty.
HP 171806	3802010	Main Bearing Kit	1
HP 171801	3901170	Machined Rod Bearings	8 pcs
HP 171952	N/A	Fractured Rod Bearings	4 prs
131401	3804896	Upper Gasket Kit	1
131402	3802375	Lower Gasket Kit	1
111237	3802160	Piston Kits	4
Piston Kit Includes			
111235	3907163	Piston	1
111208	3901793	Pin	1
111209	3901706	Retainers	2
HP 505080	3802230	Ring Set	1

4B SERIES

4BS104-(*) REBUILD KITS			
PAI Ref.	OEM Ref.	Description	Qty.
HP 171806	3802010	Main Bearing Kit	1
HP 171801	3901170	Machined Rod Bearings	8 pcs
HP 171952	N/A	Fractured Rod Bearings	4 prs
131401	3804896	Upper Gasket Kit	1
131402	3802375	Lower Gasket Kit	1
111252	3802170	Piston Kits	4
Piston Kit Includes			
111250	3911400	Piston	1
111208	3901793	Pin	1
111209	3901706	Retainers	2
HP 505080	3802230	Ring Set	1

(P) = PREMIUM • (P+)=PREMIUM PLUS • (E)=EARLY STYLE SLEEVE KITS • (C)=CURRENT STYLE SLEEVE KITS
KITS ARE AVAILABLE WITH OVERSIZED LINERS & BEARINGS (CALL TECHNICAL SUPPORT FOR DASH #'s)

Please note: Specify size of Rod Bearings and Main Bearings when ordering Rebuild Kits. All OEM references shown are examples of standard sizes. Other sizes are available. Please call for correct dash number for application. **MUST VERIFY BY SERIAL AND ARRANGEMENT.**



WORLD TESTED. PERFORMANCE PROVEN.



PAI CUMMINS ENGINE KITS

ISO 9001 CERTIFIED

HP PART(S) AVAILABLE IN STANDARD AND HIGH PERFORMANCE

4B SERIES

HP 4BS107-(*) REBUILD KITS			
PAI Ref.	OEM Ref.	Description	Qty.
HP 171806	3802010	Main Bearing Kit	1
HP 171801	3901170	Machined Rod Bearings	8 pcs
HP 171952	N/A	Fractured Rod Bearings	4 prs
131401	3804896	Upper Gasket Kit	1
131402	3802375	Lower Gasket Kit	1
HP 111312	3802248	Piston Kits	4
Piston Kit Includes			
HP 111310	3919041	Piston	1
HP 111213	3934047	Pin	1
111209	3901706	Retainers	2
HP 505080	3802230	Ring Set	1

4B SERIES

4BS108-(*) REBUILD KITS			
PAI Ref.	OEM Ref.	Description	Qty.
HP 171806	3802010	Main Bearing Kit	1
HP 171801	3901170	Machined Rod Bearings	8 pcs
HP 171952	N/A	Fractured Rod Bearings	4 prs
131401	3804896	Upper Gasket Kit	1
131402	3802375	Lower Gasket Kit	1
111343	3802773	Piston Kits	4
Piston Kit Includes			
111341	3921880	Piston	1
HP 111213	3934047	Pin	1
111209	3901706	Retainers	2
505083	3802040	Ring Set	1

4B SERIES

4BS109-(*) REBUILD KITS			
PAI Ref.	OEM Ref.	Description	Qty.
HP 171806	3802010	Main Bearing Kit	1
HP 171801	3901170	Machined Rod Bearings	8 pcs
HP 171952	N/A	Fractured Rod Bearings	4 prs
131401	3804896	Upper Gasket Kit	1
131402	3802375	Lower Gasket Kit	1
HP 111396	3802757	Piston Kits	4
Piston Kit Includes			
111395	3930187	Piston	1
HP 111213	3934047	Pin	1
111209	3901706	Retainers	2
HP 505075	3802040	Ring Set	1

4B SERIES

4BS110-(*) REBUILD KITS			
PAI Ref.	OEM Ref.	Description	Qty.
HP 171806	3802010	Main Bearing Kit	1
HP 171801	3901170	Machined Rod Bearings	8 pcs
HP 171952	N/A	Fractured Rod Bearings	4 prs
131401	3804896	Upper Gasket Kit	1
131402	3802375	Lower Gasket Kit	1
111424	3802561	Piston Kits	4
Piston Kit Includes			
111422	3926631	Piston	1
HP 111213	3934047	Pin	1
111209	3901706	Retainers	2
HP 505080	3802230	Ring Set	1

(P) = PREMIUM • (P+)=PREMIUM PLUS • (E)=EARLY STYLE SLEEVE KITS • (C)=CURRENT STYLE SLEEVE KITS
 KITS ARE AVAILABLE WITH OVERSIZED LINERS & BEARINGS (CALL TECHNICAL SUPPORT FOR DASH #'s)

Please note: Specify size of Rod Bearings and Main Bearings when ordering Rebuild Kits. All OEM references shown are examples of standard sizes. Other sizes are available. Please call for correct dash number for application. **MUST VERIFY BY SERIAL AND ARRANGEMENT.**



PAI CUMMINS ENGINE KITS

ISO 9001 CERTIFIED

HP PART(S) AVAILABLE IN STANDARD AND HIGH PERFORMANCE

4B SERIES

4BS112-(*) REBUILD KITS			
PAI Ref.	OEM Ref.	Description	Qty.
HP 171806	3802010	Main Bearing Kit	1
HP 171801	3901170	Machined Rod Bearings	8 pcs
HP 171952	N/A	Fractured Rod Bearings	4 prs
131602	4089648	Upper Gasket Kit	1
131402	3802375	Lower Gasket Kit	1
111591	3957797	Piston Kits	4
Piston Kit Includes			
111589	3957795	Piston	1
HP 111213	3934047	Pin	1
111209	3901706	Retainers	2
505150	4089460	Ring Set	1

4B SERIES

4BS113-(*) INFRAME KITS			
PAI Ref.	OEM Ref.	Description	Qty.
HP 171806	3802010	Main Bearing Kit	1
HP 171801	3901170	Machined Rod Bearings	8 pcs
HP 171952	N/A	Fractured Rod Bearings	4 prs
131883	3802242	Upper Gasket Kit	1
131402	3802375	Lower Gasket Kit	1
111628	3957797	Piston Kits	4
Piston Kit Includes			
111626	3935591	Piston	1
HP 111213	3934047	Pin	1
111209	3901706	Retainers	2
505180	3802831	Ring Set	1

FOR OUR COMPLETE CUMMINS ENGINE SELECTION CALL 770.822.1000

(P) = PREMIUM • (P+)=PREMIUM PLUS • (E)=EARLY STYLE SLEEVE KITS • (C)=CURRENT STYLE SLEEVE KITS
 KITS ARE AVAILABLE WITH OVERSIZED LINERS & BEARINGS (CALL TECHNICAL SUPPORT FOR DASH #'s)

Please note: Specify size of Rod Bearings and Main Bearings when ordering Rebuild Kits. All OEM references shown are examples of standard sizes. Other sizes are available. Please call for correct dash number for application. **MUST VERIFY BY SERIAL AND ARRANGEMENT.**



PAI CUMMINS ENGINE KITS

ISO 9001 CERTIFIED

HP PART(S) AVAILABLE IN STANDARD AND HIGH PERFORMANCE

6B SERIES

6BS101-(*) REBUILD KITS			
PAI Ref.	OEM Ref.	Description	Qty.
HP 171811	3802070	Main Bearing Kit	1
HP 171801	3901170	Machined Rod Bearings	12 pcs
HP 171952	N/A	Fractured Rod Bearings	6 prs
131404	3804897	Upper Gasket Kit	1
131405	3802376	Lower Gasket Kit	1
111217	3802060	Piston Kits	6
Piston Kit Includes			
111215	3906223	Piston	1
111208	3901793	Pin	1
111209	3901706	Retainers	2
505083	3802040	Ring Set	1

6B SERIES

6BS102-(*) REBUILD KITS			
PAI Ref.	OEM Ref.	Description	Qty.
HP 171811	3802070	Main Bearing Kit	1
HP 171801	3901170	Machined Rod Bearings	12 pcs
HP 171952	N/A	Fractured Rod Bearings	6 prs
131404	3804897	Upper Gasket Kit	1
131405	3802376	Lower Gasket Kit	1
111222	3802100	Piston Kits	6
Piston Kit Includes			
111220	3907156	Piston	1
111208	3901793	Pin	1
111209	3901706	Retainers	2
HP 505080	3802230	Ring Set	1

6B SERIES

6BS103-(*) REBUILD KITS			
PAI Ref.	OEM Ref.	Description	Qty.
HP 171811	3802070	Main Bearing Kit	1
HP 171801	3901170	Machined Rod Bearings	12 pcs
HP 171952	N/A	Fractured Rod Bearings	6 prs
131404	3804897	Upper Gasket Kit	1
131405	3802376	Lower Gasket Kit	1
111237	3802160	Piston Kits	6
Piston Kit Includes			
111235	3907163	Piston	1
111208	3901793	Pin	1
111209	3901706	Retainers	2
HP 505080	3802230	Ring Set	1

6B SERIES

6BS104-(*) REBUILD KITS			
PAI Ref.	OEM Ref.	Description	Qty.
HP 171811	3802070	Main Bearing Kit	1
HP 171801	3901170	Machined Rod Bearings	12 pcs
HP 171952	N/A	Fractured Rod Bearings	6 prs
131404	3804897	Upper Gasket Kit	1
131405	3802376	Lower Gasket Kit	1
111252	3802170	Piston Kits	6
Piston Kit Includes			
111250	3911400	Piston	1
111208	3901793	Pin	1
111209	3901706	Retainers	2
HP 505080	3802230	Ring Set	1

(P) = PREMIUM • (P+)=PREMIUM PLUS • (E)=EARLY STYLE SLEEVE KITS • (C)=CURRENT STYLE SLEEVE KITS
 KITS ARE AVAILABLE WITH OVERSIZED LINERS & BEARINGS (CALL TECHNICAL SUPPORT FOR DASH #'s)

Please note: Specify size of Rod Bearings and Main Bearings when ordering Rebuild Kits. All OEM references shown are examples of standard sizes. Other sizes are available. Please call for correct dash number for application. **MUST VERIFY BY SERIAL AND ARRANGEMENT.**



PAI CUMMINS ENGINE KITS

ISO 9001 CERTIFIED

HP PART(S) AVAILABLE IN STANDARD AND HIGH PERFORMANCE

6B SERIES

6BS105-(*) REBUILD KITS			
PAI Ref.	OEM Ref.	Description	Qty.
HP 171811	3802070	Main Bearing Kit	1
HP 171801	3901170	Machined Rod Bearings	12 pcs
HP 171952	N/A	Fractured Rod Bearings	6 prs
131404	3804897	Upper Gasket Kit	1
131405	3802376	Lower Gasket Kit	1
111323	3802251	Piston Kits	6
Piston Kit Includes			
111321	3917619	Piston	1
HP 111213	3934047	Pin	1
111209	3901706	Retainers	2
HP 505080	3802230	Ring Set	1

6B SERIES

HP 6BS106-(*) REBUILD KITS			
PAI Ref.	OEM Ref.	Description	Qty.
HP 171811	3802070	Main Bearing Kit	1
HP 171801	3901170	Machined Rod Bearings	12 pcs
HP 171952	N/A	Fractured Rod Bearings	6 prs
131404	3804897	Upper Gasket Kit	1
131405	3802376	Lower Gasket Kit	1
HP 111333	3802488	Piston Kits	6
Piston Kit Includes			
HP 111331	3922577	Piston	1
HP 111213	3934047	Pin	1
111209	3901706	Retainers	2
HP 505080	3802230	Ring Set	1

6B SERIES

6BS107-(*) REBUILD KITS			
PAI Ref.	OEM Ref.	Description	Qty.
HP 171811	3802070	Main Bearing Kit	1
HP 171801	3901170	Machined Rod Bearings	12 pcs
HP 171952	N/A	Fractured Rod Bearings	6 prs
131404	3804897	Upper Gasket Kit	1
131405	3802376	Lower Gasket Kit	1
HP 111312	3802248	Piston Kits	6
Piston Kit Includes			
HP 111310	3919041	Piston	1
HP 111213	3934047	Pin	1
111209	3901706	Retainers	2
HP 505080	3802230	Ring Set	1

6B SERIES

6BS108-(*) REBUILD KITS			
PAI Ref.	OEM Ref.	Description	Qty.
HP 171811	3802070	Main Bearing Kit	1
HP 171801	3901170	Machined Rod Bearings	12 pcs
HP 171952	N/A	Fractured Rod Bearings	6 prs
131404	3804897	Upper Gasket Kit	1
131405	3802376	Lower Gasket Kit	1
111343	3802773	Piston Kits	6
Piston Kit Includes			
111341	3921880	Piston	1
HP 111213	3934047	Pin	1
111209	3901706	Retainers	2
505083	3802040	Ring Set	1

(P) = PREMIUM • (P+)=PREMIUM PLUS • (E)=EARLY STYLE SLEEVE KITS • (C)=CURRENT STYLE SLEEVE KITS
KITS ARE AVAILABLE WITH OVERSIZED LINERS & BEARINGS (CALL TECHNICAL SUPPORT FOR DASH #'s)

Please note: Specify size of Rod Bearings and Main Bearings when ordering Rebuild Kits. All OEM references shown are examples of standard sizes. Other sizes are available. Please call for correct dash number for application. **MUST VERIFY BY SERIAL AND ARRANGEMENT.**



MACK • CUMMINS • DETROIT DIESEL CATERPILLAR • FULLER • ROCKWELL • EATON INTERNATIONAL • GENUINE HENDRICKSON

ENGINE PARTS • BODY PARTS • ELECTRICAL COMPONENTS • OIL & WATER PUMPS • CHASSIS
DRIVELINE REPLACEMENT PARTS • POWER STEERING COMPONENTS • TAPPETS • SENSORS

For more information about PAI's complete product line and services, please visit www.paiindustries.com or call us at 770.822.1000.



PAI CUMMINS ENGINE KITS

ISO 9001 CERTIFIED

HP PART(S) AVAILABLE IN STANDARD AND HIGH PERFORMANCE

6B SERIES

HP 6BS109-(*) REBUILD KITS			
PAI Ref.	OEM Ref.	Description	Qty.
HP 171811	3802070	Main Bearing Kit	1
HP 171801	3901170	Machined Rod Bearings	12 pcs
HP 171952	N/A	Fractured Rod Bearings	6 prs
131404	3804897	Upper Gasket Kit	1
131405	3802376	Lower Gasket Kit	1
HP 111396	3802757	Piston Kits	6
Piston Kit Includes			
HP 111395	3930187	Piston	1
HP 111213	3934047	Pin	1
111209	3901706	Retainers	2
HP 505075	3802040	Ring Set	1

6B SERIES

6BS110-(*) REBUILD KITS			
PAI Ref.	OEM Ref.	Description	Qty.
HP 171811	3802070	Main Bearing Kit	1
HP 171801	3901170	Machined Rod Bearings	12 pcs
HP 171952	N/A	Fractured Rod Bearings	6 prs
131404	3804897	Upper Gasket Kit	1
131405	3802376	Lower Gasket Kit	1
111424	3802561	Piston Kits	6
Piston Kit Includes			
111422	3926631	Piston	1
HP 111213	3934047	Pin	1
111209	3901706	Retainers	2
HP 505080	3802230	Ring Set	1

6B SERIES

6BS112-(*) REBUILD KITS			
PAI Ref.	OEM Ref.	Description	Qty.
HP 171811	3802070	Main Bearing Kit	1
HP 171801	3901170	Machined Rod Bearings	12 pcs
HP 171952	N/A	Fractured Rod Bearings	6 prs
131404	3804897	Upper Gasket Kit	1
131405	3802376	Lower Gasket Kit	1
111591	N/A	Piston Kits	6
Piston Kit Includes			
111589	3957795	Piston	1
HP 111213	3934047	Pin	1
111209	3901706	Retainers	2
505150	4089460	Ring Set	1

6B SERIES

6BS113-(*) REBUILD KITS			
PAI Ref.	OEM Ref.	Description	Qty.
HP 171811	3802070	Main Bearing Kit	1
HP 171801	3901170	Machined Rod Bearings	12 pcs
HP 171952	N/A	Fractured Rod Bearings	6 prs
131404	3804897	Upper Gasket Kit	1
131405	3802376	Lower Gasket Kit	1
111628	N/A	Piston Kits	6
Piston Kit Includes			
111626	3935591	Piston	1
HP 111213	3934047	Pin	1
111209	3901706	Retainers	2
505180	3802831	Ring Set	1

(P) = PREMIUM • (P+)=PREMIUM PLUS • (E)=EARLY STYLE SLEEVE KITS • (C)=CURRENT STYLE SLEEVE KITS
KITS ARE AVAILABLE WITH OVERSIZED LINERS & BEARINGS (CALL TECHNICAL SUPPORT FOR DASH #'s)

Please note: Specify size of Rod Bearings and Main Bearings when ordering Rebuild Kits. All OEM references shown are examples of standard sizes. Other sizes are available. Please call for correct dash number for application. **MUST VERIFY BY SERIAL AND ARRANGEMENT.**



PAI CUMMINS ENGINE KITS

ISO 9001 CERTIFIED

HP PART(S) AVAILABLE IN STANDARD AND HIGH PERFORMANCE

6B SERIES

6BS201-(*) REBUILD KITS CNG - GAS 10.5CR			
PAI Ref.	OEM Ref.	Description	Qty.
HP 171811	3802070	Main Bearing Kit	1
HP 171801	3901170	Machined Rod Bearings	12 pcs
HP 171952	N/A	Fractured Rod Bearings	6 prs
131404	3804897	Upper Gasket Kit	1
131405	3802376	Lower Gasket Kit	1
111679	3802630	Piston Kits	6
Piston Kit Includes			
111677	3922687	Piston	1
HP 111213	3934047	Pin	1
111209	3901706	Retainers	2
505154	3802951	Ring Set	1

6B SERIES

6BS202-(*) REBUILD KITS LPG - GAS 9.3 CR			
PAI Ref.	OEM Ref.	Description	Qty.
HP 171811	3802070	Main Bearing Kit	1
HP 171801	3901170	Machined Rod Bearings	12 pcs
HP 171952	N/A	Fractured Rod Bearings	6 prs
131404	3804897	Upper Gasket Kit	1
131405	3802376	Lower Gasket Kit	1
111688	3802952	Piston Kits	6
Piston Kit Includes			
111686	3930503	Piston	1
HP 111213	3934047	Pin	1
111209	3901706	Retainers	2
505154	3802951	Ring Set	1

PAI MANUFACTURING IN THE UNITED STATES SINCE 1973

(P) = PREMIUM • (P+)=PREMIUM PLUS • (E)=EARLY STYLE SLEEVE KITS • (C)=CURRENT STYLE SLEEVE KITS
KITS ARE AVAILABLE WITH OVERSIZED LINERS & BEARINGS (CALL TECHNICAL SUPPORT FOR DASH #'s)

Please note: Specify size of Rod Bearings and Main Bearings when ordering Rebuild Kits. All OEM references shown are examples of standard sizes. Other sizes are available. Please call for correct dash number for application. **MUST VERIFY BY SERIAL AND ARRANGEMENT.**



PAI CUMMINS ENGINE KITS

ISO 9001 CERTIFIED

HP PART(S) AVAILABLE IN STANDARD AND HIGH PERFORMANCE

ISB & QSB SERIES

ISB403-(*) REBUILD KITS			
PAI Ref.	OEM Ref.	Description	Qty.
HP 171806	3802010	Main Bearing Kit	1
HP 171801	3901170	Machined Rod Bearings	8 pcs
HP 171952	N/A	Fractured Rod Bearings	4 prs
131404	3804897	Upper Gasket Kit	1
131405	3802376	Lower Gasket Kit	1
111442	3804980	Piston Kits	4
Piston Kit Includes			
111443	3932514	Piston	1
HP 111213	3934047	Pin	1
111209	3901706	Retainers	2
505130	3804930	Ring Set	1

ISB & QSB SERIES

ISB404-(*) REBUILD KITS			
PAI Ref.	OEM Ref.	Description	Qty.
HP 171806	3802010	Main Bearing Kit	1
HP 171801	3901170	Machined Rod Bearings	8 pcs
HP 171952	N/A	Fractured Rod Bearings	4 prs
131401	2881955	Upper Gasket Kit	1
131402	3802375	Lower Gasket Kit	1
111533	4089461	Piston Kits	4
Piston Kit Includes			
111531	3957416	Piston	1
HP 111213	3934047	Pin	1
111209	3901706	Retainers	2
505150	4089460	Ring Set	1

ISB & QSB SERIES

ISB407-(*) REBUILD KITS FRACTURED ROD			
PAI Ref.	OEM Ref.	Description	Qty.
HP 171806	3802010	Main Bearing Kit	1
HP 171952	N/A	Fractured Rod Bearings	4 prs
131863	4089780	Upper Gasket Kit	1
131830	4025108	Lower Gasket Kit	1
136026	3909410	Front Seal	1
HP 111542	4089259	Piston Kits	4
Piston Kit Includes			
HP 111540	3965497	Piston	1
HP 111213	3934047	Pin	1
111209	3901706	Retainers	2
HP 505105	3804990	Ring Set	1

ISB & QSB SERIES

ISB410-(*) REBUILD KITS FRACTURED ROD			
PAI Ref.	OEM Ref.	Description	Qty.
HP 171806	3802010	Main Bearing Kit	1
HP 171952	N/A	Fractured Rod Bearings	4 prs
131863	4089780	Upper Gasket Kit	1
131830	4025108	Lower Gasket Kit	1
111612	4025072	Piston Kits	4
Piston Kit Includes			
111610	3972880	Piston	1
HP 111213	3934047	Pin	1
111209	3901706	Retainers	2
HP 505105	3804990	Ring Set	1

Please note: Specify size of Rod Bearings and Main Bearings when ordering Rebuild Kits. All OEM references shown are examples of standard sizes. Other sizes are available. Please call for correct dash number for application. **MUST VERIFY BY SERIAL AND ARRANGEMENT.**



PAI CUMMINS ENGINE KITS

ISO 9001 CERTIFIED

HP PART(S) AVAILABLE IN STANDARD AND HIGH PERFORMANCE

ISB & QSB SERIES

ISB411-(*) REBUILD KITS FRACTURED ROD

PAI Ref.	OEM Ref.	Description	Qty.
HP 171806	3802010	Main Bearing Kit	1
172080	N/A	Fractured Rod Bearings	4 prs
131602	4089648	Upper Gasket Kit	1
131402	3802375	Lower Gasket Kit	1
136105	3937111	Front Seal	1
111715	N/A	Piston Kits	4
Piston Kit Includes			
111713	3939398	Piston	1
111086	3939374	Pin	1
111097	3939375	Retainers	2
505150	4089460	Ring Set	1

ISB & QSB SERIES

ISB412-(*) REBUILD KITS FRACTURED ROD

PAI Ref.	OEM Ref.	Description	Qty.
HP 171806	3802010	Main Bearing Kit	1
172080	N/A	Fractured Rod Bearings	4 prs
131602	4089648	Upper Gasket Kit	1
131402	3802375	Lower Gasket Kit	1
136105	3937111	Front Seal	1
111752	4089725	Piston Kits	4
Piston Kit Includes			
111750	3969000	Piston	1
111086	3939374	Pin	1
111097	3939375	Retainers	2
505150	4089460	Ring Set	1

ISB & QSB SERIES

ISB430-(*) REBUILD KITS ISB4.5 LITER ENGINE - FRACTURED ROD

PAI Ref.	OEM Ref.	Description	Qty.
HP 171806	3802010	Main Bearing Kit	1
HP 171952	N/A	Fractured Rod Bearings	4 prs
131824	4955356	Upper Gasket Kit	1
131864	4955357	Lower Gasket Kit	1
136123	4955372	Front Seal	1
111555	N/A	Piston Kits	4
Piston Kit Includes			
111553	4934860	Piston	1
111088	4931041	Pin	1
111209	3901706	Retainers	2
505160	4955251	Ring Set	1

Please note: Specify size of Rod Bearings and Main Bearings when ordering Rebuild Kits. All OEM references shown are examples of standard sizes. Other sizes are available. Please call for correct dash number for application. **MUST VERIFY BY SERIAL AND ARRANGEMENT.**



PAI CUMMINS ENGINE KITS

ISO 9001 CERTIFIED

HP PART(S) AVAILABLE IN STANDARD AND HIGH PERFORMANCE

ISB & QSB SERIES

ISB431-(*) REBUILD KITS FRACTURED ROD - NON-EGR ENGINE OUT OF FRAME KIT ISB4.5 LITER ENGINE			
PAI Ref.	OEM Ref.	Description	Qty.
HP 171806	3802010	Main Bearing Kit	1
HP 171952	N/A	Rod Bearings	4 pcs
131824	4955356	Upper Gasket Kit	1
131864	4955357	Lower Gasket Kit	1
172040	3945528	Lower Thrust Bearing	1
136126	3926126	Front Seal	1
111622	N/A	Piston Kits	4
Piston Kit Includes			
111620	4939619	Piston	1
111088	4931041	Pin	1
111209	3901706	Retainers	2
505160	4955251	Ring Set	1

ISB & QSB SERIES

ISB440-(*) REBUILD KITS PISTONLESS KIT			
PAI Ref.	OEM Ref.	Description	Qty.
HP 171806	3802010	Main Bearing Kit	1
HP 171952	N/A	Rod Bearings	4 pcs
131863	4089780	Upper Gasket Kit	1
131830	4025108	Lower Gasket Kit	1

ISB & QSB SERIES

ISB432-(*) REBUILD KITS FRACTURED ROD ISB4.5 LITER ENGINE			
PAI Ref.	OEM Ref.	Description	Qty.
HP 171806	3802010	Main Bearing Kit	1
172080	3901170	Fractured Rod Bearings	4 pcs
131602	4089648	Upper Gasket Kit	1
131402	3802375	Lower Gasket Kit	1
111723	4089726	Piston Kits	4
Piston Kit Includes			
111721	3969036	Piston	1
111086	3939374	Pin	1
111097	3939375	Retainers	2
505130	3804930	Ring Set	1

ISB & QSB SERIES

ISB601-(*) REBUILD KITS DODGE TRUCK - STD HP			
PAI Ref.	OEM Ref.	Description	Qty.
HP 171811	3802070	Main Bearing Kit	1
HP 171801	3901170	Machined Rod Bearings	12 pcs
HP 171952	N/A	Fractured Rod Bearings	6 prs
131566	4089790	Upper Gasket Kit	1
131608	3800833	Lower Gasket Kit	1
111457	3800781	Piston Kits	6
Piston Kit Includes			
111455	3946153	Piston	1
HP 111213	3934047	Pin	1
111209	3901706	Retainers	2
HP 505105	3804990	Ring Set	1

(P) = PREMIUM • (P+)=PREMIUM PLUS • (E)=EARLY STYLE SLEEVE KITS • (C)=CURRENT STYLE SLEEVE KITS
KITS ARE AVAILABLE WITH OVERSIZED LINERS & BEARINGS (CALL TECHNICAL SUPPORT FOR DASH #'s)

Please note: Specify size of Rod Bearings and Main Bearings when ordering Rebuild Kits. All OEM references shown are examples of standard sizes. Other sizes are available. Please call for correct dash number for application. **MUST VERIFY BY SERIAL AND ARRANGEMENT.**



PAI CUMMINS ENGINE KITS

ISO 9001 CERTIFIED

HP PART(S) AVAILABLE IN STANDARD AND HIGH PERFORMANCE

ISB & QSB SERIES

ISB602-(*) REBUILD KITS DODGE TRUCK - HIGH HP			
PAI Ref.	OEM Ref.	Description	Qty.
HP 171811	3802070	Main Bearing Kit	1
HP 171801	3901170	Fractured Rod Bearings	12 pcs
131566	4089790	Upper Gasket Kit	1
131608	3800833	Lower Gasket Kit	1
111467	3800838	Piston Kits	6
Piston Kit Includes			
111465	3946050	Piston	1
HP 111213	3934047	Pin	1
111209	3901706	Retainers	2
HP 505105	3804990	Ring Set	1

ISB & QSB SERIES

HP ISB605-(*) REBUILD KITS EGR - NON-EGR ENGINE			
PAI Ref.	OEM Ref.	Description	Qty.
HP 171811	3802070	Main Bearing Kit	1
HP 171801	3901170	Machined Rod Bearings	12 pcs
HP 171952	N/A	Fractured Rod Bearings	6 prs
131683	4089819	Upper Gasket Kit	1
131734	4089263		
131685	4089173	Lower Gasket Kit	1
131739	4089264		
136105	3937111	Front Seal	1
136026	3909410	Rear Seal	1
HP 111502	4089260	Piston Kits	6
Piston Kit Includes			
HP 111500	3958675	Piston	1
HP 111213	3934047	Pin	1
111209	3901706	Retainers	2
HP 505133	4089258	Ring Set	1

ISB & QSB SERIES

ISB604-(*) REBUILD KITS			
PAI Ref.	OEM Ref.	Description	Qty.
HP 171811	3802070	Main Bearing Kit	1
HP 171801	3901170	Machined Rod Bearings	12 pcs
HP 171952	N/A	Fractured Rod Bearings	6 prs
131404	3804897	Upper Gasket Kit	1
131405	3802376	Lower Gasket Kit	1
192110	3957912	Valve Seals	12
111533	4089461	Piston Kits	6
Piston Kit Includes			
111531	3957416	Piston	1
HP 111213	3934047	Pin	1
111209	3901706	Retainers	2
505150	4089460	Ring Set	1

ISB & QSB SERIES

HP ISB606-(*) REBUILD KITS			
PAI Ref.	OEM Ref.	Description	Qty.
HP 171811	3802070	Main Bearing Kit	1
HP 171801	3901170	Machined Rod Bearings	12 pcs
HP 171952	N/A	Fractured Rod Bearings	6 prs
131683	4089819	Upper Gasket Kit	1
131685	4089173	Lower Gasket Kit	1
136105	3937111	Front Seal	1
136026	3909410	Rear Seal	1
HP 111523	4089669	Piston Kits	6
Piston Kit Includes			
HP 111521	3970192	Piston	1
HP 111213	3934047	Pin	1
111209	3901706	Retainers	2
HP 505105	3004990	Ring Set	1



PAI CUMMINS ENGINE KITS

ISO 9001 CERTIFIED

HP PART(S) AVAILABLE IN STANDARD AND HIGH PERFORMANCE

ISB & QSB SERIES

HP ISB607-001-300 REBUILD KITS EGR ENGINE			
PAI Ref.	OEM Ref.	Description	Qty.
HP 171811	3802070	Main Bearing Kit	1
HP 171801	3901170	Machined Rod Bearings	12 pcs
HP 171952	N/A	Fractured Rod Bearings	6 prs
131683	4089819	Upper Gasket Kit	1
131734	4089263		1
131685	4089173	Lower Gasket Kit	1
131739	4089264		1
136105	3937111	Front Seal	1
136026	3909410	Rear Seal	1
HP 111542	4089259	Piston Kits	6
Piston Kit Includes			
HP 111540	3965497	Piston	1
HP 111213	3934047	Pin	1
111209	3901706	Retainers	2
HP 505105	3804990	Ring Set	1

ISB & QSB SERIES

HP ISB607-301 REBUILD KITS NON-EGR ENGINE			
PAI Ref.	OEM Ref.	Description	Qty.
HP 171811	3802070	Main Bearing Kit	1
HP 171801	3901170	Machined Rod Bearings	12 pcs
HP 171952	N/A	Fractured Rod Bearings	6 prs
131880	4089957	Upper Gasket Kit	1
131865	4089956	Lower Gasket Kit	1
136084	3802820	Front Seal	1
136126	3926126	Rear Seal	1
HP 111542	4089259	Piston Kits	6
Piston Kit Includes			
HP 111540	3965497	Piston	1
HP 111213	3934047	Pin	1
111209	3901706	Retainers	2
HP 505105	3804990	Ring Set	1

(P) = PREMIUM • (P+)=PREMIUM PLUS • (E)=EARLY STYLE SLEEVE KITS • (C)=CURRENT STYLE SLEEVE KITS
KITS ARE AVAILABLE WITH OVERSIZED LINERS & BEARINGS (CALL TECHNICAL SUPPORT FOR DASH #'s)

Please note: Specify size of Rod Bearings and Main Bearings when ordering Rebuild Kits. All OEM references shown are examples of standard sizes. Other sizes are available. Please call for correct dash number for application. **MUST VERIFY BY SERIAL AND ARRANGEMENT.**



WORLD TESTED. PERFORMANCE PROVEN.



PAI CUMMINS ENGINE KITS

ISO 9001 CERTIFIED

HP PART(S) AVAILABLE IN STANDARD AND HIGH PERFORMANCE

ISB & QSB SERIES

ISB608-(*) REBUILD KITS			
PAI Ref.	OEM Ref.	Description	Qty.
HP 171811	3802070	Main Bearing Kit	1
HP 171801	3901170	Machined Rod Bearings	12 pcs
HP 171952	N/A	Fractured Rod Bearings	6 prs
131566	4089790	Upper Gasket Kit	1
131608	3800833	Lower Gasket Kit	1
131899	3800487		
136105	3937111	Front Seal	1
111574	N/A	Piston Kits	6
111577	N/A		
111580	N/A		
Piston Kit Includes			
111572	3948465	Piston	1
HP 111213	3934047	Pin	1
111209	3901706	Retainers	2
505170	3802919	Ring Set	1
505172	3802917		
505174	3802918		

ISB SERIES

ISB609-(*) REBUILD KITS			
PAI Ref.	OEM Ref.	Description	Qty.
HP 171811	3802070	Main Bearing Kit	1
HP 171801	3901170	Machined Rod Bearings	12 pcs
HP 171952	N/A	Fractured Rod Bearings	6 prs
131566	4089790	Upper Gasket Kit	1
131726	3800487	Lower Gasket Kit	1
111603	N/A	Piston Kits	6
Piston Kit Includes			
111601	3944073	Piston	1
HP 111213	3934047	Pin	1
111209	3901706	Retainers	2
505170	3802919	Ring Set	1

ISB SERIES

ISB610-(*) REBUILD KITS			
PAI Ref.	OEM Ref.	Description	Qty.
HP 171811	3802070	Main Bearing Kit	1
HP 171952	N/A	Fractured Rod Bearings	6 prs
131867	4089781	Upper Gasket Kit	1
131799	4025139	Lower Gasket Kit	1
111612	4025072	Piston Kits	6
Piston Kit Includes			
111610	3972880	Piston	1
HP 111213	3934047	Pin	1
111209	3901706	Retainers	2
HP 505105	3804990	Ring Set	1

(P) = PREMIUM • (P+)=PREMIUM PLUS • (E)=EARLY STYLE SLEEVE KITS • (C)=CURRENT STYLE SLEEVE KITS
 KITS ARE AVAILABLE WITH OVERSIZED LINERS & BEARINGS (CALL TECHNICAL SUPPORT FOR DASH #'s)

Please note: Specify size of Rod Bearings and Main Bearings when ordering Rebuild Kits. All OEM references shown are examples of standard sizes. Other sizes are available. Please call for correct dash number for application. **MUST VERIFY BY SERIAL AND ARRANGEMENT.**



PAI CUMMINS ENGINE KITS

ISO 9001 CERTIFIED

HP PART(S) AVAILABLE IN STANDARD AND HIGH PERFORMANCE

ISB SERIES

ISB630-(*) REBUILD KITS QSB 6.7L			
PAI Ref.	OEM Ref.	Description	Qty.
HP 171811	3802070	Main Bearing Kit	1
HP 171952	N/A	Rod Bearings	6 prs
131754	4955229	Upper Gasket Kit	1
131798	4955230	Lower Gasket Kit	1
111555	N/A	Piston Kits	6
Piston Kit Includes			
111553	4934860	Piston	1
111088	4931041	Pin	1
111209	3901706	Retainers	2
505160	4955251	Ring Set	1

ISB SERIES

ISB631-476-500 OUT OF FRAME KITS 6.7L EGR ENGINE			
PAI Ref.	OEM Ref.	Description	Qty.
HP 171811	3802070	Main Bearing Kit	1
HP 171952	N/A	Rod Bearings	6 prs
131754	4955229	Upper Gasket Kit	1
131839	N/A	Pan Gasket Kit	1
116222	N/A	Piston Kits	6
Piston Kit Includes			
111620	4939619	Piston	1
111088	4931041	Pin	1
111209	3901706	Retainers	2
505160	4955251	Ring Set	1

ISB SERIES

ISB631-076-475 OUT OF FRAME KITS 6.7L EGR ENGINE			
PAI Ref.	OEM Ref.	Description	Qty.
HP 171811	3802070	Main Bearing Kit	1
HP 171952	N/A	Fractured Rod Bearings	6 prs
131754	4955229	Upper Gasket Kit	1
131756	4955523		
131850	4955354		
131798	4955230	Lower Gasket Kit	1
131854	4955522		
131869	4955355		
136105	3937111	Front Seal	1
136026	3909410	Rear Seal	1
136158	5259499		
111622	N/A	Piston Kits	6
Piston Kit Includes			
111620	4939619	Piston	1
111088	4931041	Pin	1
111209	3901706	Retainers	2
505160	4955251	Ring Set	1

(P) = PREMIUM • (P+)=PREMIUM PLUS • (E)=EARLY STYLE SLEEVE KITS • (C)=CURRENT STYLE SLEEVE KITS
KITS ARE AVAILABLE WITH OVERSIZED LINERS & BEARINGS (CALL TECHNICAL SUPPORT FOR DASH #'s)

Please note: Specify size of Rod Bearings and Main Bearings when ordering Rebuild Kits. All OEM references shown are examples of standard sizes. Other sizes are available. Please call for correct dash number for application. **MUST VERIFY BY SERIAL AND ARRANGEMENT.**



PAI CUMMINS ENGINE KITS

ISO 9001 CERTIFIED

HP PART(S) AVAILABLE IN STANDARD AND HIGH PERFORMANCE

ISB SERIES

ISB631-076-475 OUT OF FRAME KITS 6.7L EGR ENGINE			
PAI Ref.	OEM Ref.	Description	Qty.
HP 171811	3802070	Main Bearing Kit	1
HP 171952	N/A	Fractured Rod Bearings	6 prs
131850	4955354	Upper Gasket Kit	1
131689	N/A	Pan Gasket Kit	1
136105	3937111	Front Seal	1
136026	3909410	Rear Seal	1
111622	N/A	Piston Kits	6
Piston Kit Includes			
111620	4939619	Piston	1
111088	4931041	Pin	1
111209	3901706	Retainers	2
505160	4955251	Ring Set	1

ISB SERIES

ISB640-(*) OUT OF FRAME KITS PISTONLESS			
PAI Ref.	OEM Ref.	Description	Qty.
HP 171811	3802070	Main Bearing Kit	1
HP 171952	N/A	Fractured Rod Bearings	6
131867	4089781	Upper Gasket Kit	1
131799	4025139	Lower Gasket Kit	1

(P) = PREMIUM • (P+)=PREMIUM PLUS • (E)=EARLY STYLE SLEEVE KITS • (C)=CURRENT STYLE SLEEVE KITS
KITS ARE AVAILABLE WITH OVERSIZED LINERS & BEARINGS (CALL TECHNICAL SUPPORT FOR DASH #'s)

Please note: Specify size of Rod Bearings and Main Bearings when ordering Rebuild Kits. All OEM references shown are examples of standard sizes. Other sizes are available. Please call for correct dash number for application. **MUST VERIFY BY SERIAL AND ARRANGEMENT.**



PAI CUMMINS ENGINE KITS

ISO 9001 CERTIFIED

HP PART(S) AVAILABLE IN STANDARD AND HIGH PERFORMANCE

6C SERIES

6CS103-(*) REBUILD KITS			
PAI Ref.	OEM Ref.	Description	Qty.
HP 171821	3945917	Main Bearing Kit	1
HP 171816	3901430	Rod Bearings	12 pcs
131407	4025271	Upper Gasket Kit	1
131408	3800558	Lower Gasket Kit	1
101070(E)	3802388	Cylinder Kits	6
101076(C)	3802406		
Cylinder Kit Includes			
111265	3917707	Piston	1
111268	3901597	Pin	1
111269	3901996	Retainers	2
505090	3802429	Ring Set	1
161631(E)	3907792	Liner Kit	1
161633(C)	3948095		
136020	3907177	Liner Kit Seal	1

6C SERIES

6CS104-(*) REBUILD KITS			
PAI Ref.	OEM Ref.	Description	Qty.
HP 171821	3945917	Main Bearing Kit	1
HP 171816	3901430	Rod Bearings	12 pcs
131407	4025271	Upper Gasket Kit	1
131408	3800558	Lower Gasket Kit	1
101071(E)	N/A	Cylinder Kits	6
101077(C)	N/A		
Cylinder Kit Includes			
111270	3919247	Piston	1
111268	3901597	Pin	1
111269	3901996	Retainers	2
505090	3802429	Ring Set	1
161631(E)	3907792	Liner Kit	1
161633(C)	3948095		
136020	3907177	Liner Kit Seal	1

6C SERIES

6CS105-(*) REBUILD KITS			
PAI Ref.	OEM Ref.	Description	Qty.
HP 171821	3945917	Main Bearing Kit	1
HP 171816	3901430	Rod Bearings	12 pcs
131407	4025271	Upper Gasket Kit	1
131408	3800558	Lower Gasket Kit	1
101072(E)	3802372	Cylinder Kits	6
101078(C)	3802405		
Cylinder Kit Includes			
111275	3919566	Piston	1
111268	3901597	Pin	1
111269	3901996	Retainers	2
505090	3802429	Ring Set	1
161631(E)	3907792	Liner Kit	1
161633(C)	3948095		
136020	3907177	Liner Kit Seal	1

6C SERIES

6CS106-(*) REBUILD KITS			
PAI Ref.	OEM Ref.	Description	Qty.
HP 171821	3945917	Main Bearing Kit	1
HP 171816	3901430	Rod Bearings	12 pcs
131407	4025271	Upper Gasket Kit	1
131408	3800558	Lower Gasket Kit	1
101084(E)	N/A	Cylinder Kits	6
101089(C)	3802660		
Cylinder Kit Includes			
111385	3922476	Piston	1
111268	3901597	Pin	1
111269	3901996	Retainers	2
505090	3802429	Ring Set	1
161631(E)	3907792	Liner Kit	1
161633(C)	3948095		
136020	3907177	Liner Kit Seal	1



PAI CUMMINS ENGINE KITS

ISO 9001 CERTIFIED

HP PART(S) AVAILABLE IN STANDARD AND HIGH PERFORMANCE

6C SERIES

6CS107-(*) REBUILD KITS			
PAI Ref.	OEM Ref.	Description	Qty.
HP 171821	3945917	Main Bearing Kit	1
HP 171816	3901430	Rod Bearings	12 pcs
131407	4025271	Upper Gasket Kit	1
131408	3800558	Lower Gasket Kit	1
101073(E)	3802400	Cylinder Kits	6
101079(C)	3802403		
Cylinder Kit Includes			
111280	3923163	Piston	1
111268	3901597	Pin	1
111269	3901996	Retainers	2
505090	3802429	Ring Set	1
161631(E)	3907792	Liner Kit	1
161633(C)	3948095		
136020	3907177	Liner Kit Seal	1

6C SERIES

6CS108-(*) REBUILD KITS			
PAI Ref.	OEM Ref.	Description	Qty.
HP 171821	3945917	Main Bearing Kit	1
HP 171816	3901430	Rod Bearings	12 pcs
131407	4025271	Upper Gasket Kit	1
131408	3800558	Lower Gasket Kit	1
101074(E)	3802401	Cylinder Kits	6
101080(C)	3802404		
Cylinder Kit Includes			
111285	3923164	Piston	1
111268	3901597	Pin	1
111269	3901996	Retainers	2
505090	3802429	Ring Set	1
161631(E)	3907792	Liner Kit	1
161633(C)	3948095		
136020	3907177	Liner Kit Seal	1

(P) = PREMIUM • (P+)=PREMIUM PLUS • (E)=EARLY STYLE SLEEVE KITS • (C)=CURRENT STYLE SLEEVE KITS
 KITS ARE AVAILABLE WITH OVERSIZED LINERS & BEARINGS (CALL TECHNICAL SUPPORT FOR DASH #'s)

Please note: Specify size of Rod Bearings and Main Bearings when ordering Rebuild Kits. All OEM references shown are examples of standard sizes. Other sizes are available. Please call for correct dash number for application. **MUST VERIFY BY SERIAL AND ARRANGEMENT.**



PAI CUMMINS ENGINE KITS

ISO 9001 CERTIFIED

HP PART(S) AVAILABLE IN STANDARD AND HIGH PERFORMANCE

6C SERIES

6CS109-(*) REBUILD KITS			
PAI Ref.	OEM Ref.	Description	Qty.
HP 171821	3945917	Main Bearing Kit	1
HP 171816	3901430	Rod Bearings	12 pcs
131407	4025271	Upper Gasket Kit	1
131408	3800558	Lower Gasket Kit	1
101075(E)	3802399	Cylinder Kits	6
101081(C)	3802402		
Cylinder Kit Includes			
111290	3923165	Piston	1
111268	3901597	Pin	1
111269	3901996	Retainers	2
505090	3802429	Ring Set	1
161631(E)	3907792	Liner Kit	1
161633(C)	3948095		
136020	3907177	Liner Kit Seal	1

6C SERIES

6CS110-(*) REBUILD KITS			
PAI Ref.	OEM Ref.	Description	Qty.
HP 171821	3945917	Main Bearing Kit	1
HP 171816	3901430	Rod Bearings	12 pcs
131407	4025271	Upper Gasket Kit	1
131408	3800558	Lower Gasket Kit	1
101187(E)	N/A	Cylinder Kits	6
101188(C)	N/A		
Cylinder Kit Includes			
111434	3923537	Piston	1
111268	3901597	Pin	1
111269	3901996	Retainers	2
505090	3802429	Ring Set	1
161631(E)	3907792	Liner Kit	1
161633(C)	3948095		
136020	3907177	Liner Kit Seal	1

6C SERIES

6CS111-(*) REBUILD KITS			
PAI Ref.	OEM Ref.	Description	Qty.
HP 171821	3945917	Main Bearing Kit	1
HP 171816	3901430	Rod Bearings	12 pcs
131407	4025271	Upper Gasket Kit	1
131408	3800558	Lower Gasket Kit	1
101091(C)	3802912	Cylinder Kits	6
Cylinder Kit Includes			
111474	3925673	Piston	1
111268	3901597	Pin	1
111269	3901996	Retainers	2
505090	3802429	Ring Set	1
161631(E)	3907792	Liner Kit	1
161633(C)	3948095		
136020	3907177	Liner Kit Seal	1

6C SERIES

6CS112-(*) REBUILD KITS			
PAI Ref.	OEM Ref.	Description	Qty.
HP 171821	3945917	Main Bearing Kit	1
HP 171816	3901430	Rod Bearings	12 pcs
131407	4025271	Upper Gasket Kit	1
131408	3800558	Lower Gasket Kit	1
101082(E)	N/A	Cylinder Kits	6
101087(C)	3802743		
Cylinder Kit Includes			
111295	3925878	Piston	1
111268	3901597	Pin	1
111269	3901996	Retainers	2
505090	3802429	Ring Set	1
161631(E)	3907792	Liner Kit	1
161633(C)	3948095		
136020	3907177	Liner Kit Seal	1

(P) = PREMIUM • (P+)=PREMIUM PLUS • (E)=EARLY STYLE SLEEVE KITS • (C)=CURRENT STYLE SLEEVE KITS
KITS ARE AVAILABLE WITH OVERSIZED LINERS & BEARINGS (CALL TECH. SUPPORT FOR DASH #'s)



PAI CUMMINS ENGINE KITS

ISO 9001 CERTIFIED

HP PART(S) AVAILABLE IN STANDARD AND HIGH PERFORMANCE

6C SERIES

6CS113-(*) REBUILD KITS			
PAI Ref.	OEM Ref.	Description	Qty.
HP 171821	3945917	Main Bearing Kit	1
HP 171816	3901430	Rod Bearings	12 pcs
131407	4025271	Upper Gasket Kit	1
131408	3800558	Lower Gasket Kit	1
101083(E)	N/A	Cylinder Kits	6
101088(C)	3925673		
Cylinder Kit Includes			
111300	3929161	Piston	1
111268	3901597	Pin	1
111269	3901996	Retainers	2
505090	3802429	Ring Set	1
161631(E)	3907792	Liner Kit	1
161633(C)	3948095		
136020	3907177	Liner Kit Seal	1

6C SERIES

6CS115-(*) REBUILD KITS NATURAL GAS			
PAI Ref.	OEM Ref.	Description	Qty.
HP 171821	3945917	Main Bearing Kit	1
HP 171816	3901430	Rod Bearings	12 pcs
131730	4025274	Upper Gasket Kit	1
131408	3800558	Lower Gasket Kit	1
101184(C)	N/A	Cylinder Kits	6
Cylinder Kit Includes			
111646	3992117	Piston	1
111268	3901597	Pin	1
111269	3901996	Retainers	2
505185	4025290	Ring Set	1
161631(E)	3907792	Liner Kit	1
161633(C)	3948095		
136020	3907177	Liner Kit Seal	1

6C SERIES

6CS116-(*) REBUILD KITS NATURAL GAS			
PAI Ref.	OEM Ref.	Description	Qty.
HP 171821	3945917	Main Bearing Kit	1
HP 171816	3901430	Rod Bearings	12 pcs
131730	4025274	Upper Gasket Kit	1
131408	3800558	Lower Gasket Kit	1
101185	N/A	Cylinder Kits	6
Cylinder Kit Includes			
111668	3992118	Piston	1
111268	3901597	Pin	1
111269	3901996	Retainers	2
505185	4025290	Ring Set	1
161633	3948095	Liner Kit	1
136020	3907177	Liner Kit Seal	1

6C SERIES

6CS117-(*) REBUILD KITS NATURAL GAS			
PAI Ref.	OEM Ref.	Description	Qty.
HP 171821	3945917	Main Bearing Kit	1
HP 171816	3901430	Rod Bearings	12 pcs
131730	4025274	Upper Gasket Kit	1
131408	3800558	Lower Gasket Kit	1
101186	N/A	Cylinder Kits	6
Cylinder Kit Includes			
111671	3394459	Piston	1
111268	3901597	Pin	1
111269	3901996	Retainers	2
505185	4025290	Ring Set	1
161633	3948095	Liner Kit	1
136020	3907177	Liner Kit Seal	1

(P) = PREMIUM • (P+)=PREMIUM PLUS • (E)=EARLY STYLE SLEEVE KITS • (C)=CURRENT STYLE SLEEVE KITS
KITS ARE AVAILABLE WITH OVERSIZED LINERS & BEARINGS (CALL TECH. SUPPORT FOR DASH #'s)



PAI CUMMINS ENGINE KITS

ISO 9001 CERTIFIED

HP PART(S) AVAILABLE IN STANDARD AND HIGH PERFORMANCE

ISC SERIES

ISC101-(*) OVERHAUL KIT			
PAI Ref.	OEM Ref.	Description	Qty.
HP 171821	3945917	Main Bearing Kit	1
HP 171816	3901430	Rod Bearings	12 pcs
131684	4089958	Upper Gasket Kit	1
131722	3800343	Lower Gasket Kit	1
101096	3800319	Cylinder Kits	6
Cylinder Kit Includes			
111480	3942106	Piston	1
111268	3901597	Pin	1
111269	3901996	Retainers	2
505090	3802429	Ring Set	1
161633	3948095	Liner Kit	1
136020	3907177	Liner Kit Seal	1

ISC SERIES

ISC102-(*) OVERHAUL KIT			
PAI Ref.	OEM Ref.	Description	Qty.
HP 171821	3945917	Main Bearing Kit	1
HP 171816	3901430	Rod Bearings	12 pcs
131684	4089958	Upper Gasket Kit	1
131722	3800343	Lower Gasket Kit	1
101097	3800321	Cylinder Kits	6
Cylinder Kit Includes			
111513	3943367	Piston	1
111268	3901597	Pin	1
111269	3901996	Retainers	2
505140	3802538	Ring Set	1
161633	3948095	Liner Kit	1
136020	3907177	Liner Kit Seal	1

ISC SERIES

HP ISC103-(*) OVERHAUL KIT			
PAI Ref.	OEM Ref.	Description	Qty.
HP 171821	3945917	Main Bearing Kit	1
HP 171816	3901430	Rod Bearings	12 pcs
131743	4089758	Upper Gasket Kit	1
131814	4089978		
131746	4089759	Lower Gasket Kit	1
131811	4089979		
HP 101182	N/A	Cylinder Kits	6
Cylinder Kit Includes			
HP 111516	3973265	Piston	1
HP 111087	3950549	Pin	1
111269	3901996	Retainers	2
HP 505139	4089644	Ring Set	1
161633	3948095	Liner Kit	1
136020	3907177	Liner Kit Seal	1

ISC SERIES

ISC104-(*) OVERHAUL KIT EGR ENGINE			
PAI Ref.	OEM Ref.	Description	Qty.
HP 171821	3945917	Main Bearing Kit	1
HP 171816	3901430	Rod Bearings	12 pcs
131885	4955644	Lower Gasket Kit	1
131874	4955643	Upper Gasket Kit	1
101103	N/A	Cylinder Kits	6
Cylinder Kit Includes			
111637	4932720	Piston	1
HP 111087	3950549	Pin	1
111269	3901996	Retainers	2
505149	4955651	Ring Set	1
161633	3948095	Liner Kit	1
136020	3907177	Liner Kit Seal	1

Please note: Specify size of Rod Bearings and Main Bearings when ordering Rebuild Kits. All OEM references shown are examples of standard sizes. Other sizes are available. Please call for correct dash number for application. **MUST VERIFY BY SERIAL AND ARRANGEMENT.**



PAI CUMMINS ENGINE KITS

ISO 9001 CERTIFIED

HP PART(S) AVAILABLE IN STANDARD AND HIGH PERFORMANCE

ISC SERIES

ISC105-(*) OVERHAUL KIT EGR ENGINE			
PAI Ref.	OEM Ref.	Description	Qty.
HP 171821	3945917	Main Bearing Kit	1
HP 171816	3901430	Rod Bearings	12 pcs
131874	4955643	Upper Gasket Kit	1
131811	4089979	Lower Gasket Kit	1
101225	N/A	Cylinder Kits	6
Cylinder Kit Includes			
111760	4943105	Piston	1
HP 111087	3950549	Pin	1
111269	3901996	Retainers	2
505195	4089933	Ring Set	1
161634	3800328	Liner Kit	1

ISL SERIES

ISL101-(*) OVERHAUL KIT			
PAI Ref.	OEM Ref.	Description	Qty.
HP 171821	3945917	Main Bearing Kit	1
171915	N/A	Rod Bearing Kits	6 prs
131743	4089758	Upper Gasket Kit	1
131746	4089759	Lower Gasket Kit	1
101189	N/A	Cylinder Kits	6
Cylinder Kit Includes			
111703	4941396	Crown	1
111704	3966721	Skirt	1
HP 111087	3950549	Pin	1
111269	3901996	Retainers	2
HP 505139	4089644	Ring Set	1
161634	3800328	Liner Kit	1

ISL SERIES

ISL102-(*) OVERHAUL KIT			
PAI Ref.	OEM Ref.	Description	Qty.
HP 171821	3945917	Main Bearing Kit	1
171915	N/A	Rod Bearing Kits	6 prs
131743	4089758	Upper Gasket Kit	1
131684	4089958		
131746	4089759	Lower Gasket Kit	1
131263	3800929		
101190	N/A	Cylinder Kits	6
Cylinder Kit Includes			
111707	4941395	Crown	1
111704	3966721	Skirt	1
HP 111087	3950549	Pin	1
111269	3901996	Retainers	2
HP 505139	4089644	Ring Set	1
161634	3800328	Liner Kit	1

ISL SERIES

ISL103-(*) OVERHAUL KIT			
PAI Ref.	OEM Ref.	Description	Qty.
HP 171821	3945917	Main Bearing Kit	1
171915	N/A	Rod Bearing Kits	6 prs
131743	4089758	Upper Gasket Kit	1
131746	4089759	Lower Gasket Kit	1
131856	4089889		
101191	N/A	Cylinder Kits	6
Cylinder Kit Includes			
111710	4941393	Crown	1
111704	3966721	Skirt	1
HP 111087	3950549	Pin	1
111269	3901996	Retainers	2
HP 505139	4089644	Ring Set	1
161634	3800328	Liner Kit	1



PAI CUMMINS ENGINE KITS

ISO 9001 CERTIFIED

HP PART(S) AVAILABLE IN STANDARD AND HIGH PERFORMANCE

ISL SERIES

ISL104-(*) OVERHAUL KIT			
PAI Ref.	OEM Ref.	Description	Qty.
HP 171821	3945917	Main Bearing Kit	1
171915	N/A	Rod Bearing Kits	6 prs
131743	4089758	Upper Gasket Kit	1
131746	4089759	Lower Gasket Kit	1
101192	N/A	Cylinder Kits	6
Cylinder Kit Includes			
111740	4941392	Crown	1
111704	3966721	Skirt	1
HP 111087	3950549	Pin	1
111269	3901996	Retainers	2
HP 505139	4089644	Ring Set	1
161634	3800328	Liner Kit	1

ISL SERIES

ISL140-(*) OUT OF FRAME KIT CROWNLESS			
PAI Ref.	OEM Ref.	Description	Qty.
HP 171821	3945917	Main Bearing Kit	1
171915	N/A	Rod Bearings	6 prs
131743	4089758	Upper Gasket Kit	1
131746	4089759	Lower Gasket Kit	1
HP 505139	4089644	Ring Sets	6
161634	3800328	Liner Kits	6
Piston Components Includes			
HP 111087	3950549	Pins	6
111269	3901996	Retainers	12

(P) = PREMIUM • (P+)=PREMIUM PLUS • (E)=EARLY STYLE SLEEVE KITS • (C)=CURRENT STYLE SLEEVE KITS
KITS ARE AVAILABLE WITH OVERSIZED LINERS & BEARINGS (CALL TECHNICAL SUPPORT FOR DASH #'s)

Please note: Specify size of Rod Bearings and Main Bearings when ordering Rebuild Kits. All OEM references shown are examples of standard sizes. Other sizes are available. Please call for correct dash number for application. **MUST VERIFY BY SERIAL AND ARRANGEMENT.**

NEED HELP IDENTIFYING PARTS?



**Contact our Technical Support Group at 866-994-3844
Submit Your Request Online at: www.paiindustries.com**

Navigate to "Online Request" by selecting "Part Tab," then "Engine Support."
After reviewing your request, the PAI Technical Support Group and the Sales Department will contact you with your requested information along with pricing and availability. Account number required.

Online Login/Registration



1

PAI HOMEPAGE

Customer "Login" and "Register" links are located to the upper right corner of our homepage.

Select Login if you have already registered (*Skip to Step 4*). To register, select the "Register" link which will take you to PAI's registration form.

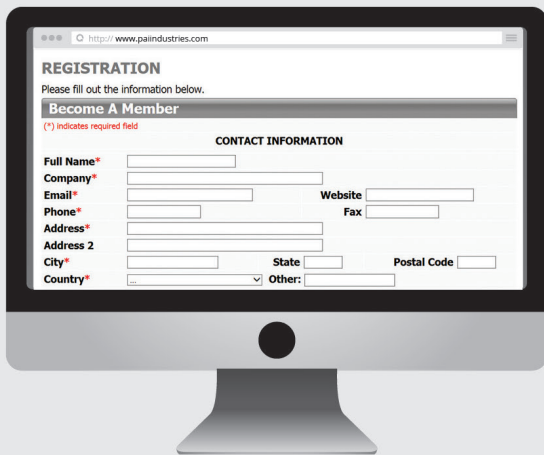

2

PAI ONLINE REGISTRATION FORM

Fill in all required fields of the registration form. After the form is completed, read our Terms and Conditions then click "Sign-Up". A confirmation "Thank You" page will appear once all required fields are filled in. (* Required Fields)

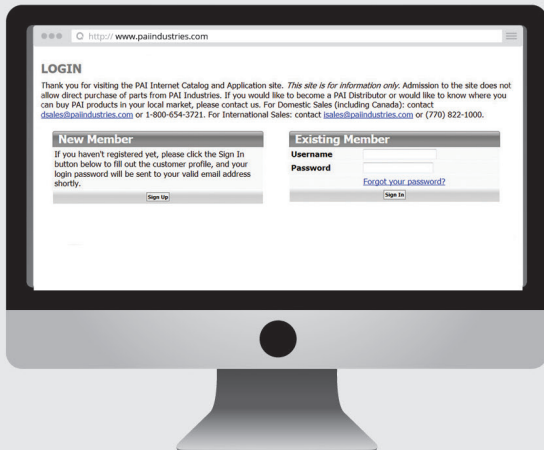

4

PAI SECURE LOGIN PAGE

To login, use the "Existing Member" box and enter your PAI "Username" and "Password" then click "Sign-In".

Search Millions of Parts

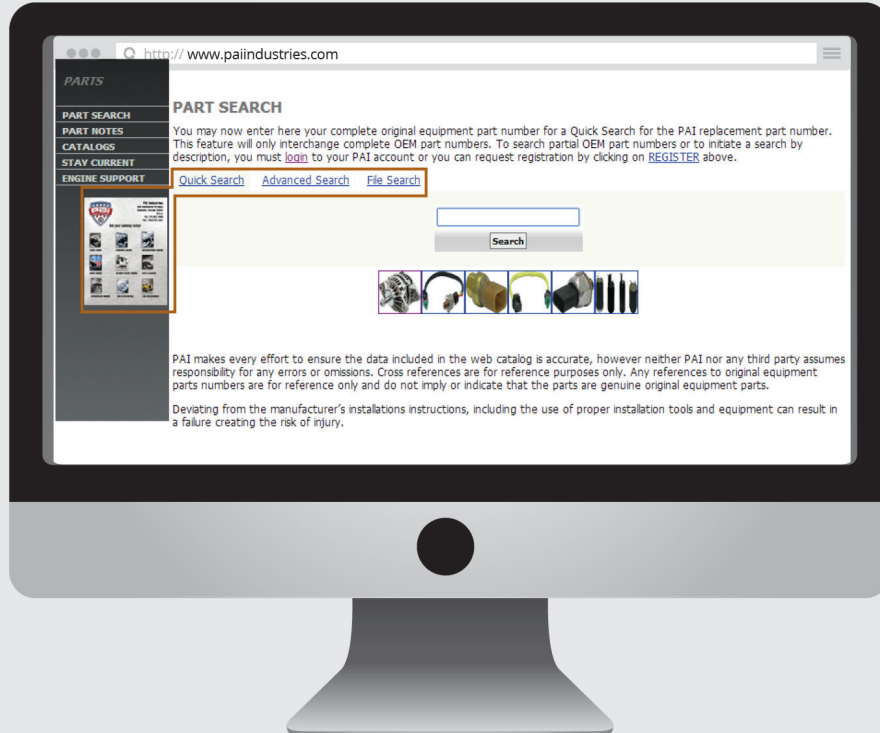

PAI PART SEARCH

Find the parts that you're looking for by using PAI's **Quick Search**, **Advance Search**, or **File Search** box to enter known PAI or OEM reference numbers.

Also, use our **PAI Catalog view** to find parts by specific application or grouped categories.

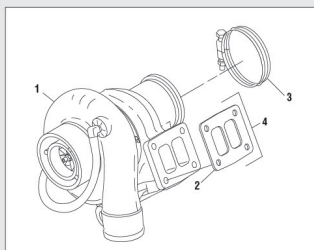

Part Illustrations

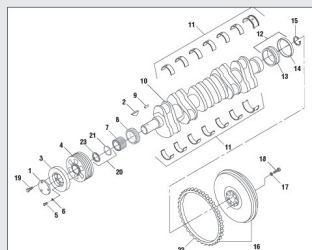

Assembly Drawing

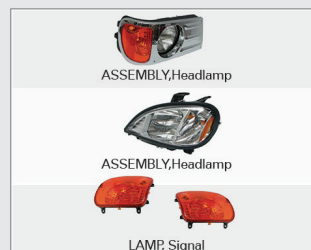

Part Photos

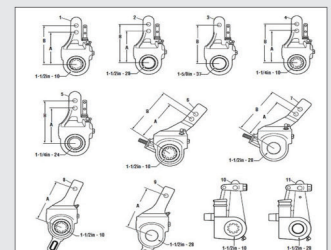

Detail Product Specs



ENGINE PARTS





HIGH PERFORMANCE ENGINES

ISO 9001 CERTIFIED

AVAILABLE HP ENGINE KITS

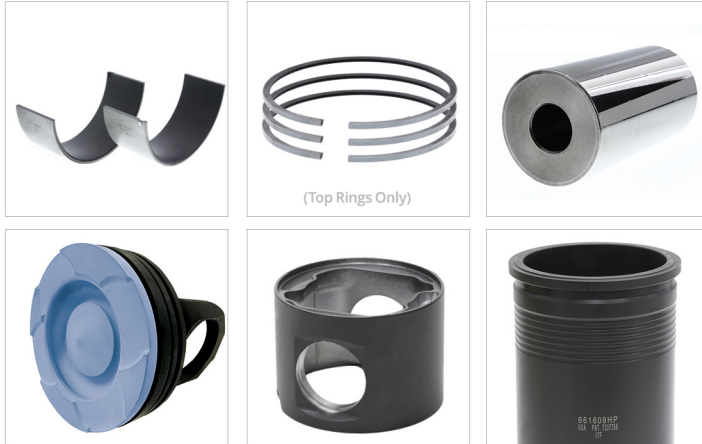

BEARINGS • RINGS • PINS • CROWNS • SKIRTS • LINERS
Manufacturing in the USA Since 1973.

HP ENGINE KITS OFFERS

- High Performance Material
- Anti-friction Properties
- Wear Resistant
- Temperature Stability
- Better Fuel Economy
- Longer Life



EXTENDED 3 YEAR WARRANTY

HIGH PERFORMANCE

CATERPILLAR HP ENGINE KITS

CAPC70101-017HP
CAPC70102-017HP
CAPC15101-010HP
CAPC15103-010HP
CAP330603-001HP
CAP340611-145HP
CAP340616-010HP

CUMMINS HP ENGINE KITS

CUPISB606-076HP
CUPISB606-101HP
CUPN14221-017HP
CUPN14222-017HP
CUP855029-017HP

DETROIT DIESEL HP ENGINE KITS

DDPS60102-033HP
DDPS60104-001HP
DDPS60104-006HP
DDPS60106-017HP
DDPS60120-017HP

INTERNATIONAL HP ENGINE KIT

NAP466111-001HP

MACK HP ENGINE KIT

PAI8036-001HP

PAI CATALOG COVERAGE



ENGINE COMPONENT CATALOGS

MACK/VOLVO APPLICATION 2018	NOV2599
CATERPILLAR 2018.....	NOV1468
INTERNATIONAL 2017	NOV1465
DETROIT DIESEL 2017.....	NOV1459
CUMMINS 2017.....	NOV1387
VOLVO/RENAULT 2014.....	NOV1065

TRUCK COMPONENT CATALOGS

AIR & ELECTRICAL CATALOG 2019	NOV2678
EXHAUST CATALOG	NOV2677
SENSOR & CONNECTOR CATALOG 2019.....	NOV2664
CAB ACCESSORIES 2018.....	NOV1512
DRIVE TRAIN 2016.....	NOV1304
WATER PUMPS,THERMOSTATS & OIL PUMPS.....	NOV1388

CUMMINS ENGINE KIT QUICK REFERENCE CHART



ISO 9001 CERTIFIED

PAI INDUSTRIES INC.
950 Northbrook Pkwy,
Suwanee, GA 30024

Phone: 770.822.1000
Fax: 770.822.1421

www.paiindustries.com



NOV1344 SEPTEMBER 2018



Connect With
Us On Social Media.

